



## **ABM Food Former NSF MODELS**

**F2000N – F3000N - F4000N - B1200N – HD3000N  
OPERATION, SERVICE MANUAL &  
PARTS LIST**

### **\* IMPORTANT SAFETY NOTICE \***

This Manual contains important safety instructions which must be strictly followed when using this equipment.



# TABLE OF CONTENTS

|   |      |
|---|------|
| INTRODUCTION                                  | Page |
| Warranty.....                                 | 3    |
| Reliability.....                              | 3    |
| GENERAL TECHNICAL FEATURES                    |      |
| Description.....                              | 4    |
| Main features.....                            | 4    |
| Safety devices.....                           | 5    |
| Components description.....                   | 5    |
| Overall measurements.....                     | 6    |
| INSTALLATION                                  |      |
| Packing check.....                            | 6    |
| Placing the machine.....                      | 6    |
| Electrical connections.....                   | 6    |
| Control panel.....                            | 7    |
| Operating test.....                           | 7    |
| UTILITY                                       |      |
| Loading the automatic paper attachment.....   | 8    |
| Product thickness regulation.....             | 9    |
| Loading the product and use.....              | 10   |
| CLEANING AND HYGIENE                          |      |
| Complete cleaning.....                        | 11   |
| Disassembly of the removable accessories..... | 11   |
| Disassembly of the paddle.....                | 11   |
| Disassembly of the hopper.....                | 11   |
| Disassembly of the conveyor belt.....         | 11   |
| Disassembly of the regulation drum.....       | 12   |
| Disassembly of the scraper.....               | 12   |
| Cleaning of the disassembled components.....  | 12   |
| Assembly of the accessories.....              | 12   |
| MAINTENANCE                                   |      |
| Ordinary maintenance.....                     | 12   |
| WIRING DIAGRAMS & SPARE PARTS                 |      |
| Wiring diagrams.....                          | 13   |
| Spare Parts.....                              | 16   |

## **WARRANTY**

The installation, the starting, and the operating of the machine must be performed by skilled personnel only, who knows the machine. The personnel assigned to the assistance and maintenance must always follow the instructions contained in the manual. The food forming machine must be used by trained personnel only. If necessary provide for the personnel's training, to learn the usual operations in order to assure the correct use of the machine.

ABM disclaims all responsibility in case of:

- Assembly of the components of the machine and the electric connection not effected according to the established rules;
- Improper use of the machine;
- Tampering the controls or the security protection;
- Use of non-original spare parts;

The warranty does not cover the normal use of the parts.

## **RELIABILITY**

In case of improper use of the machine, it is possible to have injuries and accidents.

The food forming machine must be used only by the personnel who must know the machine and the content of the manual:

- Make sure that unskilled personnel – and especially children – do not operate the machine;
- Do not modify or remove the safety devices (covers and protections), especially those installed at the meat inlet;
- Never tamper with the electric system;
- Use the machine with concentration avoiding distractions;
- Before cleaning and maintenance, always disconnect the machine from the supply system;
- Periodically check the main supply wire, in case of breaks or bad functioning, provide for the replacement by skilled personnel.
- Never go near the machine with loose hair, clothes, bracelets, chains, rings, ties, etc. to avoid the chance that they become tangled in the moving parts of the machine;
- Stop the machine whenever it makes strange noises during the functioning;
- Always keep the working area clean and dry;
- Do not deal with the repairs if you are not able to eliminate the possible breakdowns, but contact the technical assistance;
- The machine is made of accessories and parts especially designed in order to reduce the maintenance and minimum.

# GENERAL TECHNICAL FEATURES

## Description

- The ABM Food Forming machine is characterized by:
- Compactness and small overall measurements and with special features, able to satisfy the producing requirements of both the great and the small distribution;
- Reliability and safety in the operation and the cleaning processes;
- Hygiene of the parts in contact with the product through the use of innovative materials conformed to the current regulations;
- Precision and compactness of the finished product;
- Strength, easy use, controls and working stationing especially designed to optimize ergonomics.

## Main Features

- The castings are made of anticorrosional thermally treated with innovative material for food, while all the other components have been made of stainless steel. These parts are particularly fit to resist the corrosive agents of the products used and are in conformity with the hygienic regulations for food;
- The moving parts are started by an electronic motor and the movement transmission operates through a chain and mechanism;
- The hopper, the paddle, the conveyor belt, the drum and the accessories are easily disassembled to effect a regular cleaning.
- The thickness of the product is adjustable;
- The quantity of the hamburgers produced per hour can be varied on request in the models with current continue motors;
- The hopper and the moving of the product operate in a continuous way and this allows a homogenous dough;
- The controls are easily identifiable and suitable to prevent accidental starting;
- The transmission parts are located inside the crankcase;
- The machine is equipped with a device which allows the cleaning of the roll during functioning (scraper) and permits the separation of the products;
- Different drums are available, suitable o the forming of products with different shapes;
- On request, the machine can be supplied with electrical motors of different tensions.

## Safety Devices

The Food Forming Machine is equipped with the following protection and safety devices:

- Safety micromagnet on the hopper;
- Plastic cover servo-assisted by a micromagnet;
- Protection and front cover of the removable parts;
- Handle of the paddle optimized to avoid crushing and use of keys or particular tools;
- Starting of the machine through reverser for servo-assisted manual or automatic control;
- Emergency button
- Materials in conformity with the food hygienic regulations and fit to guarantee the good resistance to oxidation.

## Components Description

### CONTENTS

1. Cover
2. Hopper
3. Protection
4. Papering attachment
5. Drum stop ring nut
6. Drum
7. Scraper
8. Leading roll
9. Led roll
10. Conveyor belt
11. Footswitch
12. Speed variator for the mod. with current continuous
13. Manual/automatic switch
14. Stop button
15. Feeding signal light
16. Stop signal light
17. Transmission protection crankcase
18. Base
19. Cover shaft

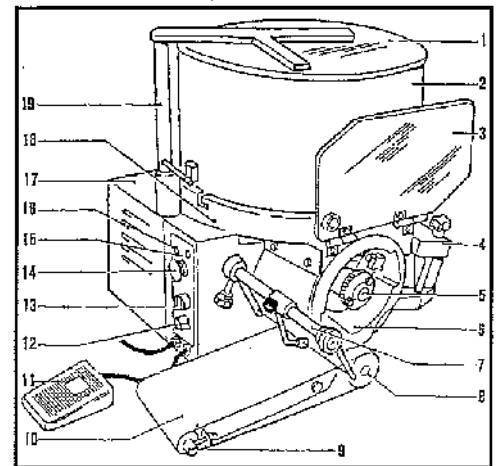

## Overall Measurements

### F2000/4000

Length (A) 620

Width (B) 500

Height (C) 610

Gross Crated Weight – 72 kg.

Net Uncrated Weight – 67 kg.

Hopper capacity – 20 kg.

Optional Conveyor Belt – 1850 x 145

Hopper Power – see identification tag

Motor Power – see identification tag

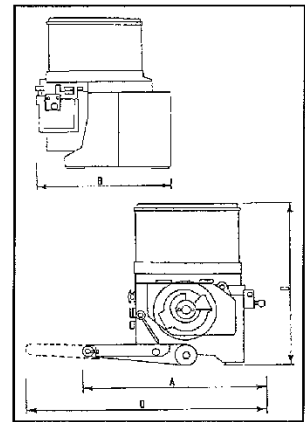

## **INSTALLATION**

### Packing Check

- At the receipt of the machine, check the package to verify that the machine has not been damaged.

The components of the package can be assimilated to the urban solid rubbish.

### Placing the Machine

- It is advisable to place the Food Forming Machine on a stable working table positioned on a height of about 800mm from the ground.
- The installation area must allow the use of the machine in an optimal and ergonomic way. It is advisable to place it in a dry, breezy place, far from warmth sources; it can be used without any special arrangement of a normal working place.

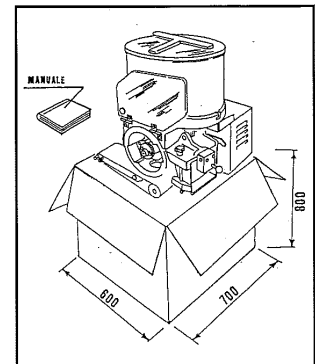

### Electrical Connections

- The machine is equipped with a feeding wire. Before connecting it to the socket, verify the functioning tension showed on the identification tag.
- In case the details do not correspond, contact the distributor for the assistance service.
- The socket for the connection must correspond to the current rules.

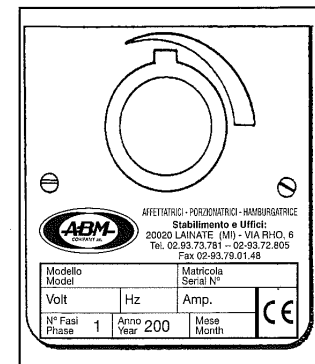

## Control Panel

- Starting switch (automatic/manual) (1)
- Red stop button (2)
- Machine operating signal lamp (3)
- Machine stop signal lamp (4)
- Handle for speed regulation (5)  
(only for model at variable speed)

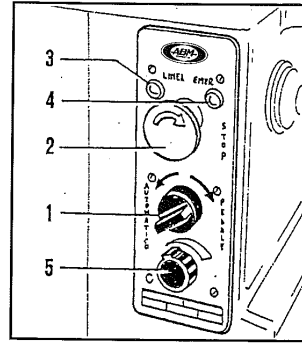

Note – in the Model F4000 the regulation of the speed and the quantity of hamburgers is made by rotating the regulating handle with a quantity of products variable from... to a maximum of 4000 pieces per hour.

## Operating Test

- Before controlling the operation, if you have not already done, you must assemble the hopper, assemble the conveyor belt, close the cover and the front protection.
- Connect the footswitch, inserting the control pipe into the bush on the control panel side.
- Connect the plug to the socket.
- Position the switch handle (1) on automatic.
- Verify the rotation of the drum and the conveyor belt (see the arrow).
- Verify the lighting of the light.
- Push the stop button (2), the machine must stop and the light (3) must light up.
- Position the switch handle (1) on manual.
- Press the footswitch.
- Verify the rotation of the drum and the conveyor belt (see the arrow).
- Verify the lighting of the light.
- Push the stop button (2). The machine must stop and the light (3) must light up.

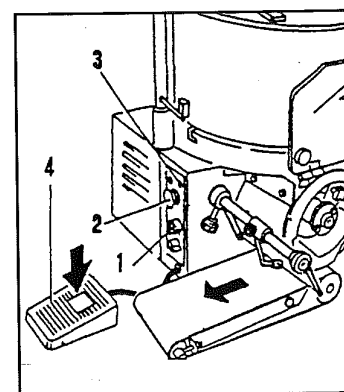
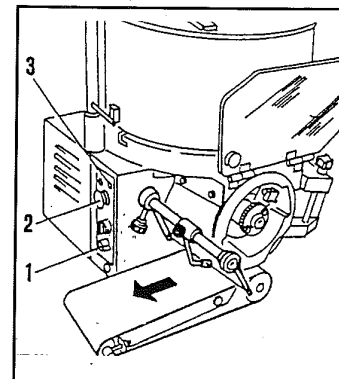
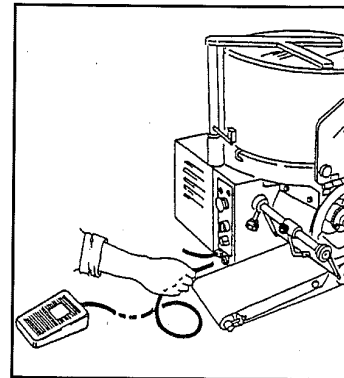



- During the operation, when lifting the front drum protection, the machine must stop.
- To continue, close drum protection, turn the operating switch again.

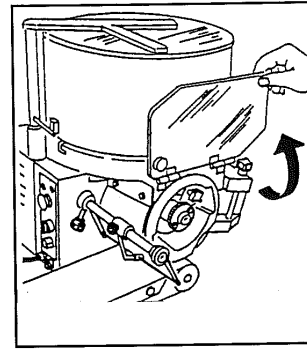

- During the operation, when rotating the hopper cover, the machine must stop.
- To continue, close hopper cover, turn the operating switch again.

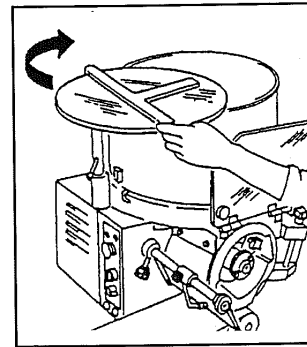

## UTILITY

To obtain good results you must use fitted meats and doughs. Arrange the machine with all the accessories disassembled.

**It is advisable not to use and let the machine function without any product in the hopper.**

### Loading the Automatic Papering Attachment

- Take out the papering attachment by pushing the button (I) and slipping it off from the guide pins.

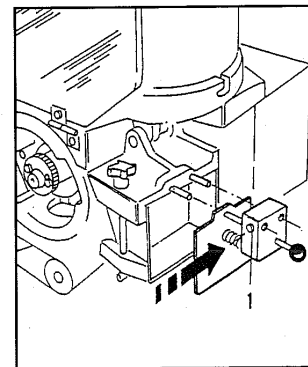

- Replace the pushing spring.
- Insert the paper block and take away the wrapper.

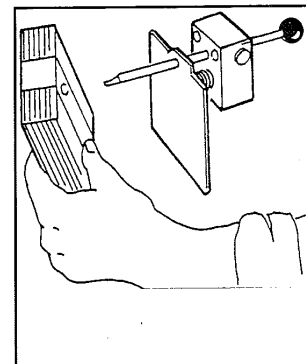

- Reassemble the papering attachment in the guide pins, until the stop click.
- Release the spring using the button placed under the papering attachment (2).

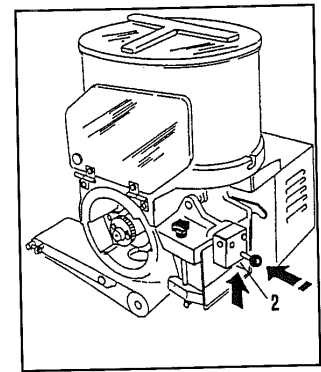

- Position the papering attachment, freeing the locking lever (2).
- Regulate the center of the paper, turning the centering knob (4).

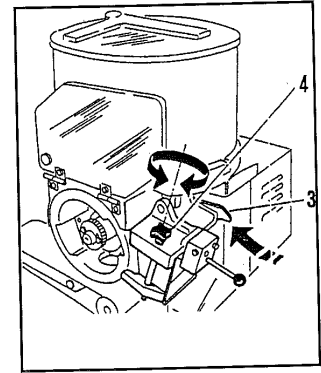

Before cleaning the machine, always make sure that the machine is stopped and disconnected from main supply.



Never use high pressure sprays during cleaning.



Never use solvents, thinners, alcohol, etc. during cleaning.



Only use lukewarm water and some neutral detergent.

### **Product Thickness Regulation**

The machine is regulated in the factory with a medium thickness; to obtain another thickness, follow the instructions indicated below:

- Take out the regulation drum by operating on the ring nut clockwise and taking out the drum.

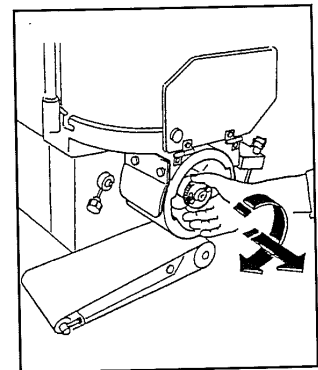

- Loosen the stop knob of the gauging device (1).
- Turn the gauging device, to regulate the thickness (2).
- Lock the stop knob (1).

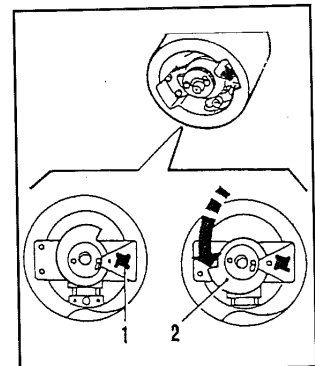

- Reassemble the drum, inserting it in the guide shaft, until the stop click.

## Loading the Product and Use

- Open the cover and load the product in the hopper and close the cover again.
- Connect the plug to the socket.

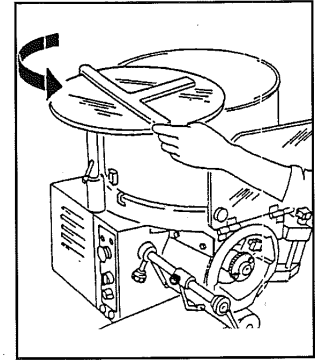

- Start the machine: push the automatic switch (1).
- Regulate the production speed with the regulation handle (2) (only for model with selector).

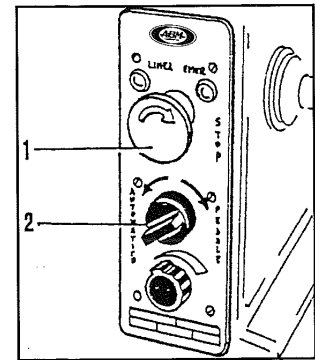

- During the operation, operate intermittently, in order to clean the drum from residual product.
- The product will come down on the conveyor belt and will be moved to its end.

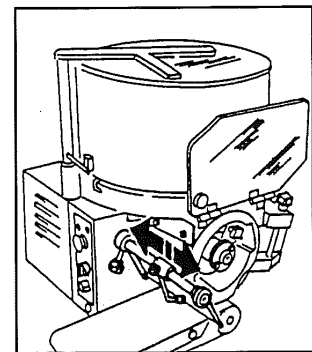

- To stop the machine, operate on the stop button (I) or open the protections.
- To continue, release the stop button and turn the start switch again (2).

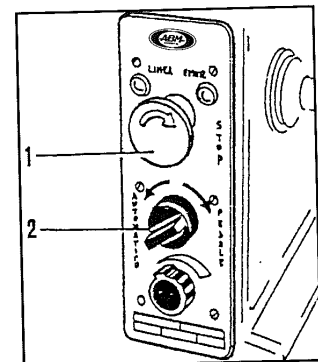

# CLEANING AND HYGIENE

## Complete Cleaning

- It is advisable to clean the machine daily or if necessary more frequently, in case it was very dirty or after long periods of inactivity.
- The cleaning must be carefully made for the parts in contact with the product.
- Clean the structure of the machine with soft cloths, sponges, and rinse with water frequently. Finally dry with soft and dry cloths.

**Attention:** the machine is not protected against steam cleaners, high pressure power washer, or similar systems. In this case there is risk of short circuit or serious damages to the machine.

## Disassembly of the Removable Accessories

- All the cleaning operations of the machine must always be done with the machine not equipped with hopper, taking out the plug from the socket.

## Disassembly of the Paddle

- Hold the handle, turn anti-clockwise and lift.
- To avoid accidents before disassembling, position the paddle away from the hopper pins.

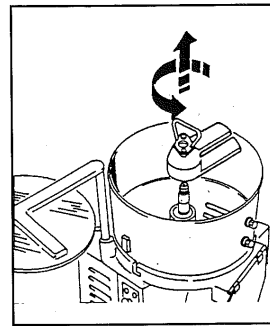

## Disassembly of the Hopper

- Open the cover completely.
- Turn the hopper anti-clockwise, lift it and take it away from the base.

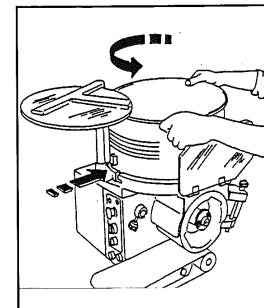

## Disassembly of the Conveyor Belt

- Lift the belt on the side of the return pulley.

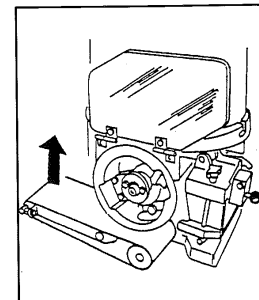

- Take off and disassemble the conveyor belt.

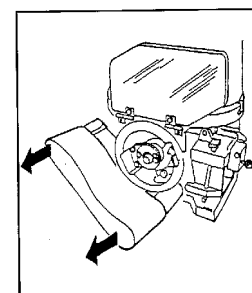

- Disassemble the complete conveyor from the guide pin.

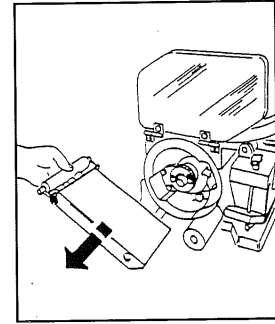

### **Disassembly of the Regulation Drum**

- Turn the stop ring nut anti-clockwise, pull the drum and disassemble it from the control pin.

### **Disassembly of the Scraper**

- Loosen the stop knob of the scraper shaft.
- Take off the complete scraper.

### **Cleaning of the Disassembled Components**

- All the disassembled components must be washed with warm water, neutral detergent, rinsed in water and dried.

### **Assembly of the Accessories**

To effect the reassembly of the accessories, proceed in the inverse way to what previously described in the disassembly. Pay special attention to the assembly of the following accessories:

- **Hopper:** Insert the hopper with the two guide pins in the fusion taking care to position the micro-magnet on the side of the cover shaft and turn it until it hooks the pins.
- **Paddle:** position the inserting shaft of the paddle so that the pins in the hopper do not overlap the paddle, then hold the paddle, put it on the shaft, making the shaft plug coincide with the housing in the drum.
- **Drum:** assembly the drum in the guide pin, making the shaft plug coincide with the housing in the drum.

## **MAINTENANCE**

### **Ordinary Maintenance**

The machine does not require a special maintenance for the regulations or replacements of parts, but only requires a normal maintenance carried out by the operator which consists of the following operations:

- Verify the operation of the micro-switches and of the electric buttons.
- Verify the state of use of the feeding wire.

Whenever there was the necessity of repairs or special maintenance, contact the assistance service or a qualified technician.





**ABM**  
**F2000N - F3000N - F4000N - B1200N**  
**NSF / ETL VERSION**  
**RECOMMENDED SPARE PARTS**  
**FROM SERIAL NUMBER: 3153 REL. 1605**

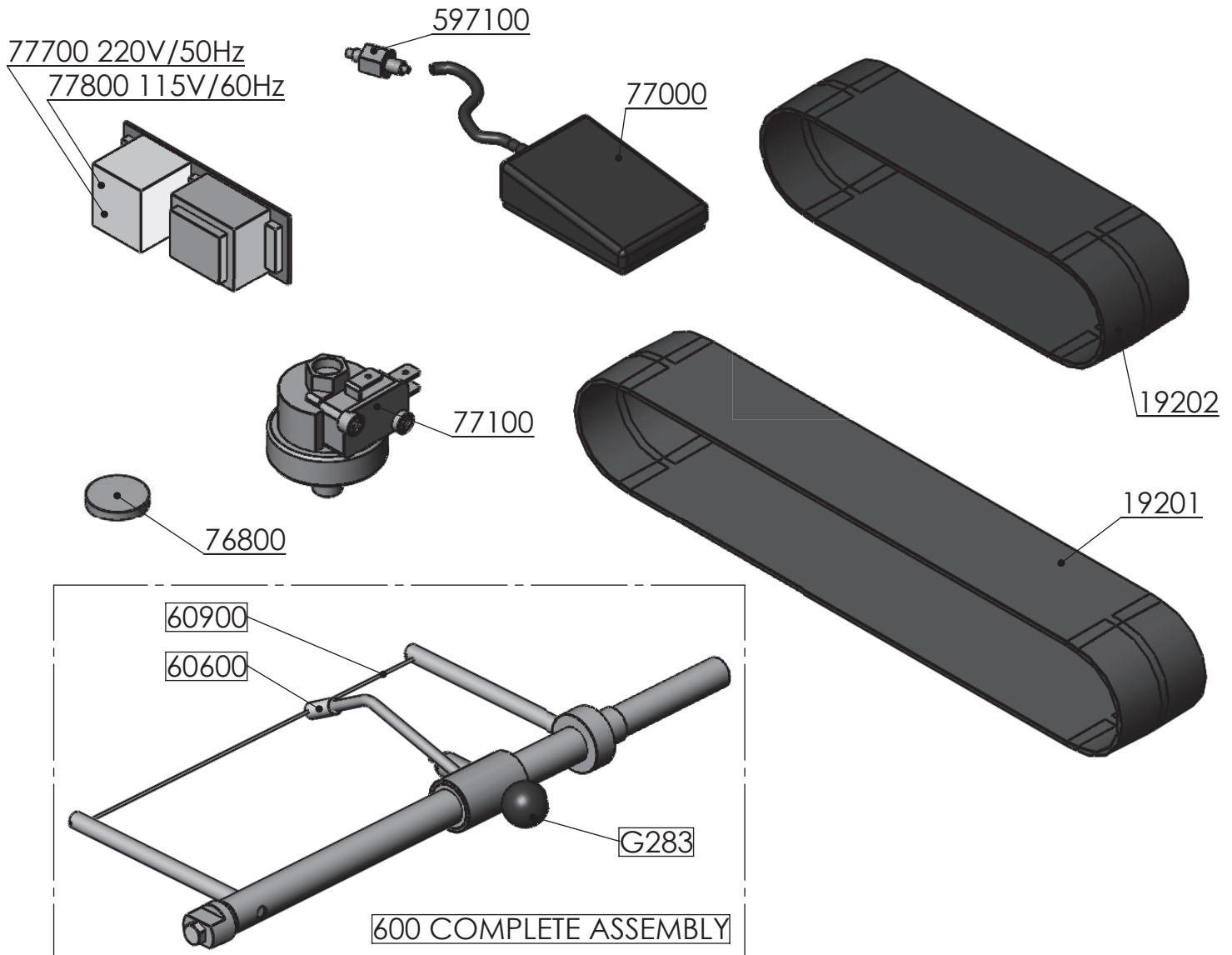

| CODE          | DESCRIPTION                             | Q.TY     |
|---------------|---|----------|
| F9319201      | LONG CONVEYOR BELT 145x1850mm           | 1        |
| F9319202      | SHORT CONVEYOR BELT 145x840mm           | 1        |
| F9360600      | WIRE CLEANER                            | 1        |
| F9360900      | S.S. WIRE                               | 1        |
| F9376800      | MAGNET                                  | 1        |
| F9377000      | FOOTSWITCH 6210-OB                      | 1        |
| F9377100      | PNEUM. SWITCH MOM.6871-01               | 1        |
| F9377700      | CARD 220/50 HZ START STOP FROM SN. 1710 | 1        |
| F9377800      | CARD 115/60 HZ START STOP FROM SN. 1710 | 1        |
| 597100        | MALE COUPLING BODY                      | 1        |
| G283          | KNOB                                    | 1        |
| CODE          | DESCRIPTION                             | Q.TY     |
| <b>F93600</b> | <b>CLEANER ASSEMBLY</b>                 | <b>1</b> |



**PNEUMATIC VERSION / ALL  
NSF / ETL VERSION  
RECOMMENDED SPARE PARTS  
FROM SERIAL NUMBER: 3153**

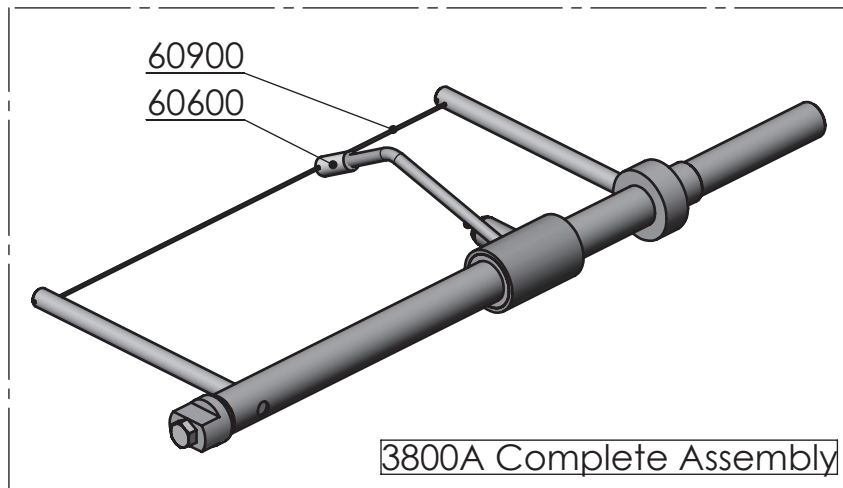
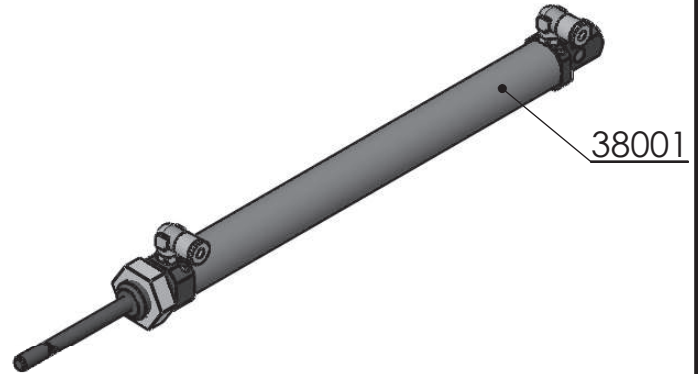
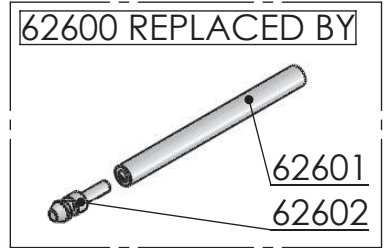
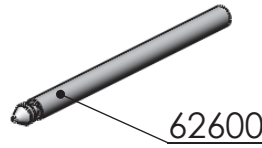
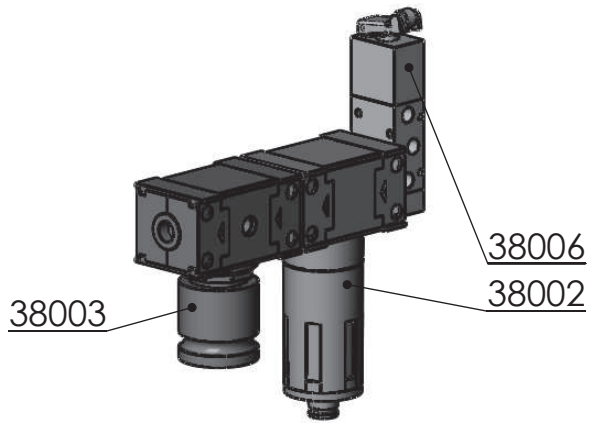

| CODE     | DESCRIPTION                         | Q.TY |
|----------|-------------------------------------|------|
| F9338001 | CILINDER - ISO 6432                 | 1    |
| F9338002 | AIR FILTER                          | 1    |
| F9338003 | FIL BIT 1/8 20 RMSA                 | 1    |
| F9338006 | SWITCH                              | 1    |
| F933800A | COMPLETE PNEUMATIC CLEANER ASSEMBLY | 1    |
| F9362601 | PNEUMATIC PISTON SHAFT              | 1    |
| F9362602 | PNEUMATIC PISTON TIP                | 1    |
| F9360600 | WIRE CLEANER                        | 1    |
| F9360900 | S.S.WIRE                            | 1    |
| CODE     | DESCRIPTION                         | Q.TY |
| F933800A | CLEANER ASSEMBLY                    | 1    |





**ABM**  
**F2000N - F3000N - F4000N - B1200N**  
**NSF / ETL VERSION**  
**FROM SERIAL NUMBER: 3153**

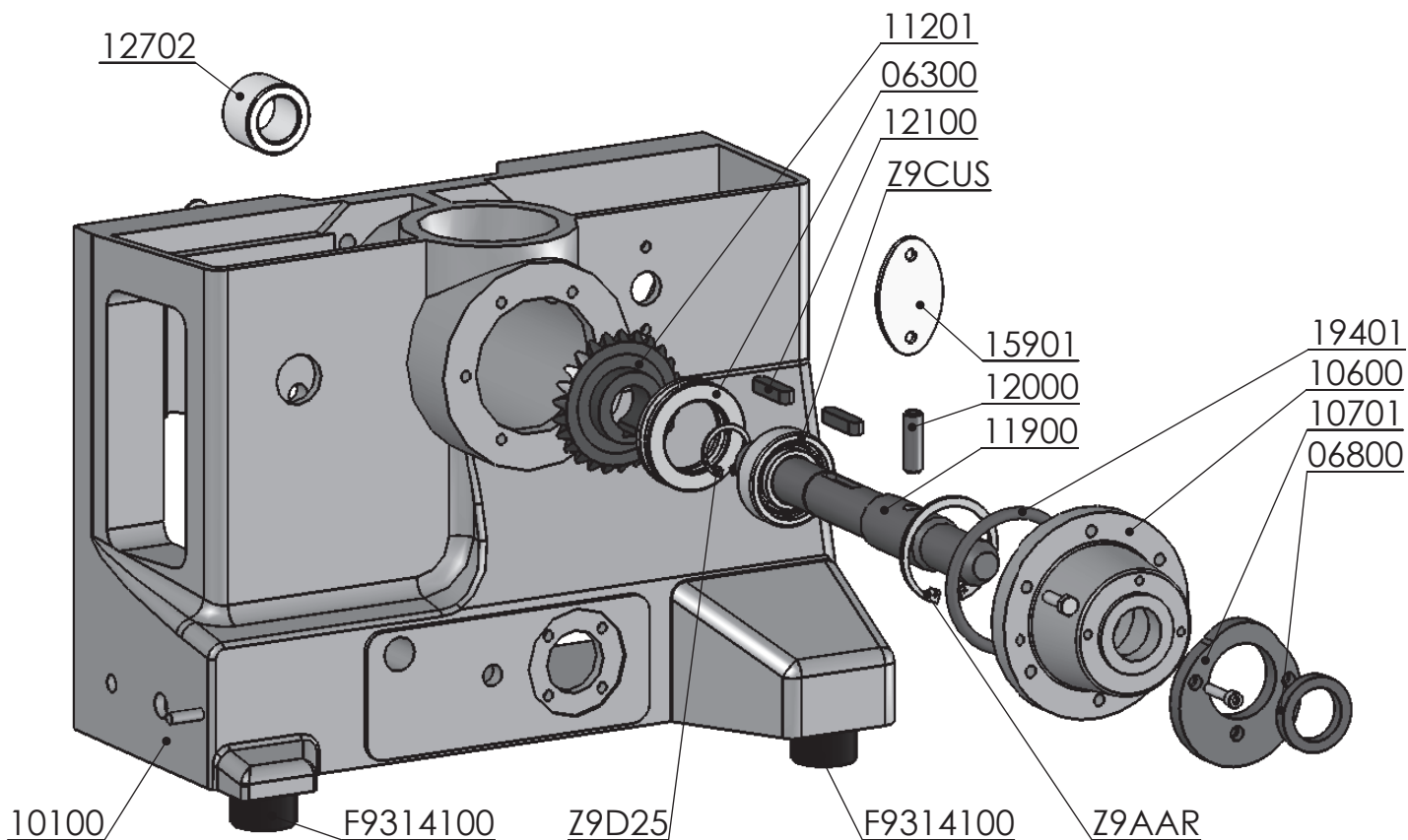

| CODE     | DESCRIPTION                    | Q.TY |
|----------|--------------------------------|------|
| F9306300 | BEARING 51108 40x60x13         | 1    |
| F9306800 | SEAL AS 30x42x7 NBR            | 1    |
| F9310100 | FRAME                          | 1    |
| F9310600 | SHAFT HOUSING                  | 1    |
| F9310701 | CAM H32                        | 1    |
| F9311201 | CONIC GEAR 25x28,2 M3 Z=25     | 1    |
| F9311900 | SHAFT d30x248                  | 1    |
| F9312000 | PLUG 10x33 h8                  | 1    |
| F9312100 | KEY 8x7x35 UNI 6605 69 A C 40  | 1    |
| F9312702 | BUSHING 26,7x32x39             | 1    |
| F9314100 | RUBBER FOOT                    | 4    |
| F9315901 | CAP                            | 1    |
| F9319401 | O RING 80x3                    | 1    |
| Z9AAR    | RETAINING RING INTERNAL M52 SS | 1    |
| Z9CUS    | BEARING 6205 2RSH 25x52x15     | 1    |
| Z9D25    | RETAINING RING EXTERNAL M25 SS | 1    |



**ABM**  
**F2000N - F3000N - F4000N - B1200N**  
**NSF / ETL VERSION**  
**FROM SERIAL NUMBER: 3153**

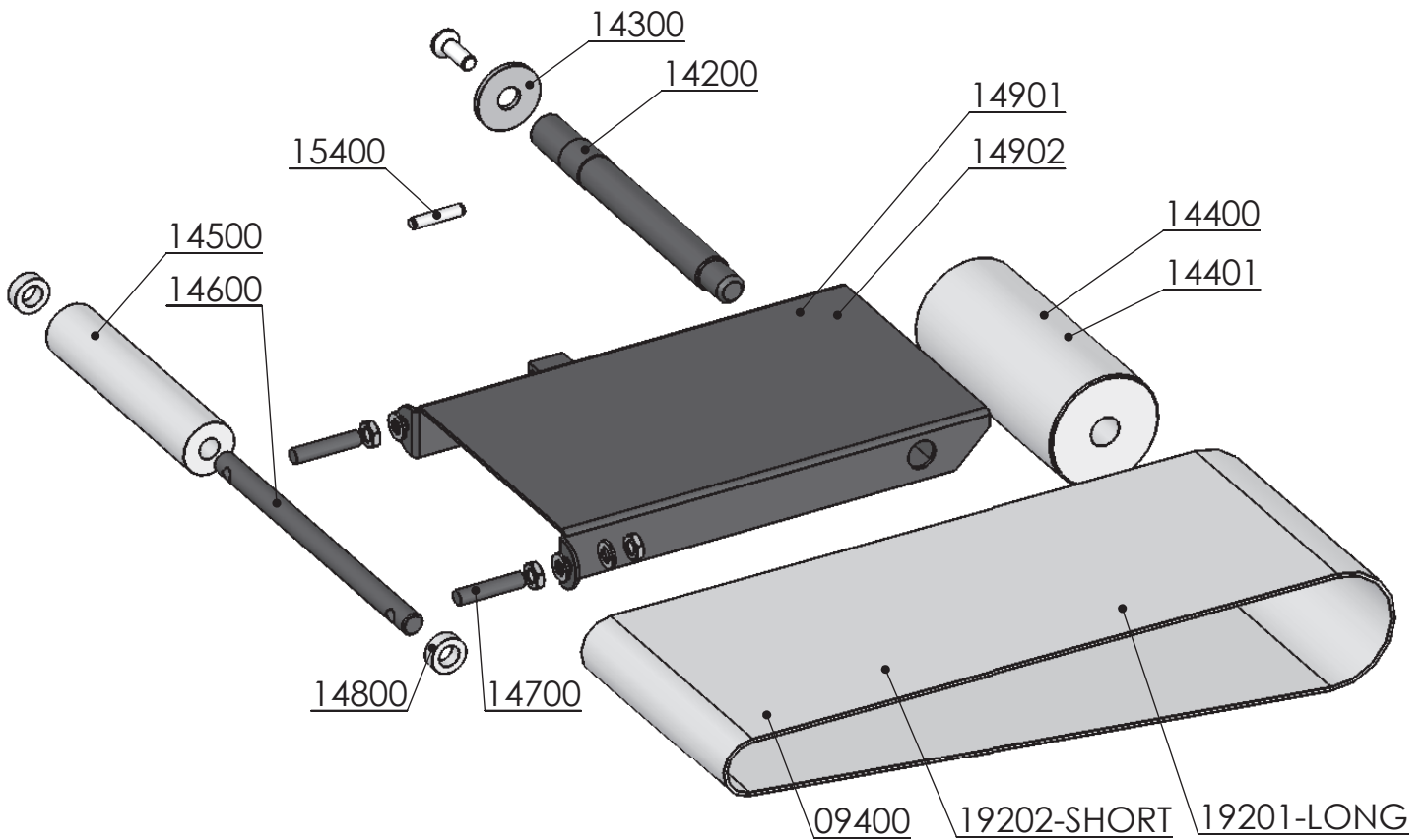

| CODE     | DESCRIPTION                   | Q.TY |
|----------|-------------------------------|------|
| F9309400 | S.S. LONG BELT                | 1    |
| F9314200 | ARM ASSY 20x187               | 1    |
| F9314300 | RING                          | 1    |
| F9314400 | CONVEYOR ROLL 64x140          | 1    |
| F9314401 | SS BELT DRIVER 64 x 140       | 1    |
| F9314500 | ROLL 28x140                   | 1    |
| F9314600 | ROLL PIN 12x193               | 1    |
| F9314700 | LOCKING SCREW M8x38           | 2    |
| F9314800 | ROLL BUSHING                  | 1    |
| F9314901 | SHORT CONVEYOR ARM            | 1    |
| F9314902 | LONG CONVEYOR ARM             | 1    |
| F9315400 | CONVEYOR ARM PIN 6x30         | 1    |
| F9319201 | LONG CONVEYOR BELT 145x1850mm | 1    |
| F9319202 | SHORT CONVEYOR BELT 145x840mm | 1    |



**ABM**  
**F2000N - F3000N - F4000N - B1200N**  
**NSF / ETL VERSION**  
**FROM SERIAL NUMBER: 3153**

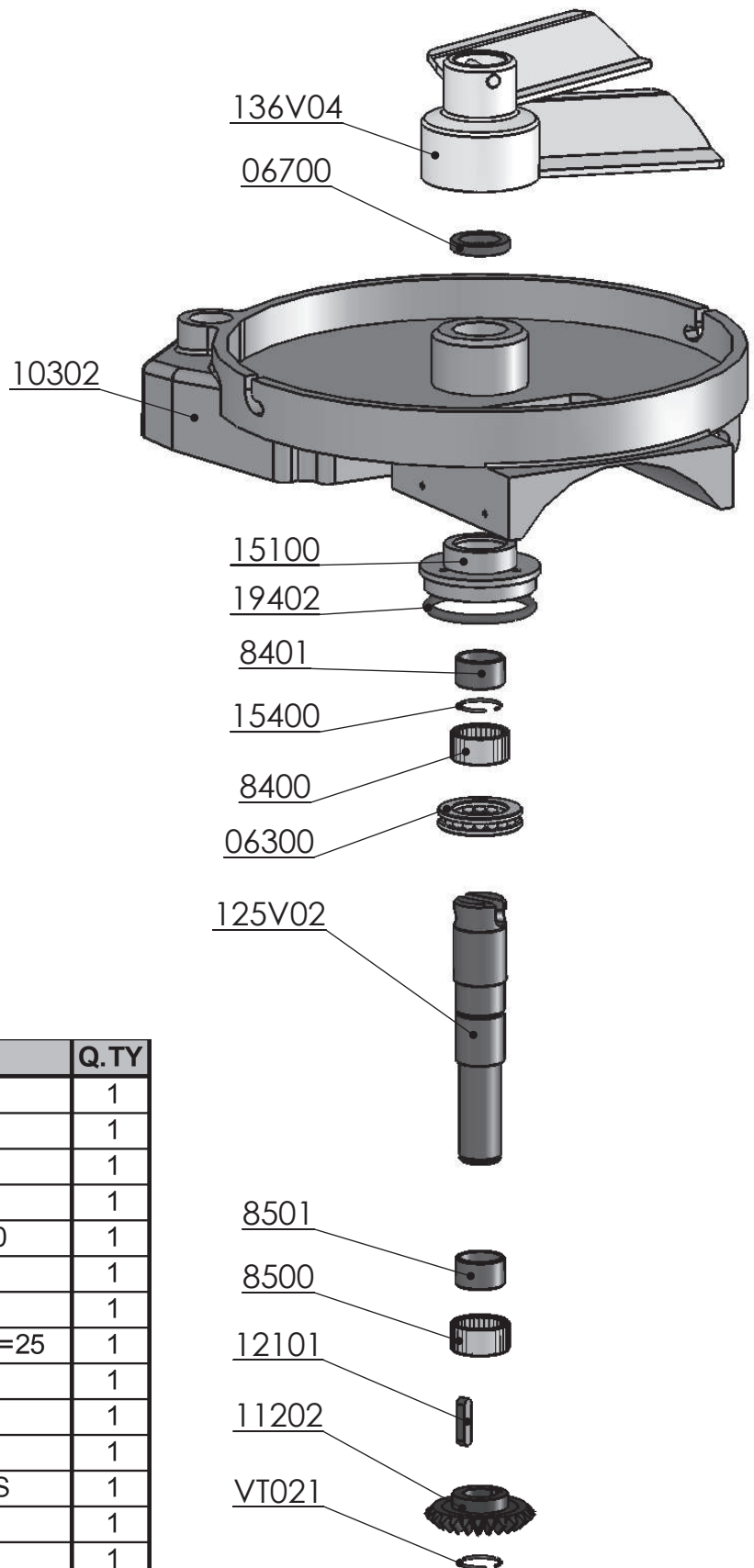

| CODE             | DESCRIPTION                | Q.TY     |
|------------------|----------------------------|----------|
| F9306300         | BEARING 51108 40x60x13     | 1        |
| F9306700         | SEAL AS 38x52x7 NBR        | 1        |
| F9308400         | BUSHING HK4020             | 1        |
| F9308401         | RING IR 35x40x20.5         | 1        |
| F9308500         | BUSHING 35x42x20 HK3520    | 1        |
| F9308501         | RING IR 30x35x20           | 1        |
| F9310302         | HOPPER PLATE               | 1        |
| F9311202         | CONIC GEAR 30x33,2 M3 Z=25 | 1        |
| F9312101         | KEY 8x8x35                 | 1        |
| F93125V02        | PADDLE SHAFT d38x182       | 1        |
| F9315100         | ALU BUSHING 87x33,5        | 1        |
| VT021            | RETAINING RING EXT 30 SS   | 1        |
| F9315400         | SNAP RING D.33             | 1        |
| F9319402         | O RING 69,3x5,7            | 1        |
| CODE             | DESCRIPTION                | Q.TY     |
| <b>F93136V04</b> | <b>PADDLE NSF VERSION</b>  | <b>1</b> |

ABM  
F2000 - F 3000 - F4000 - B1200 - HD3000

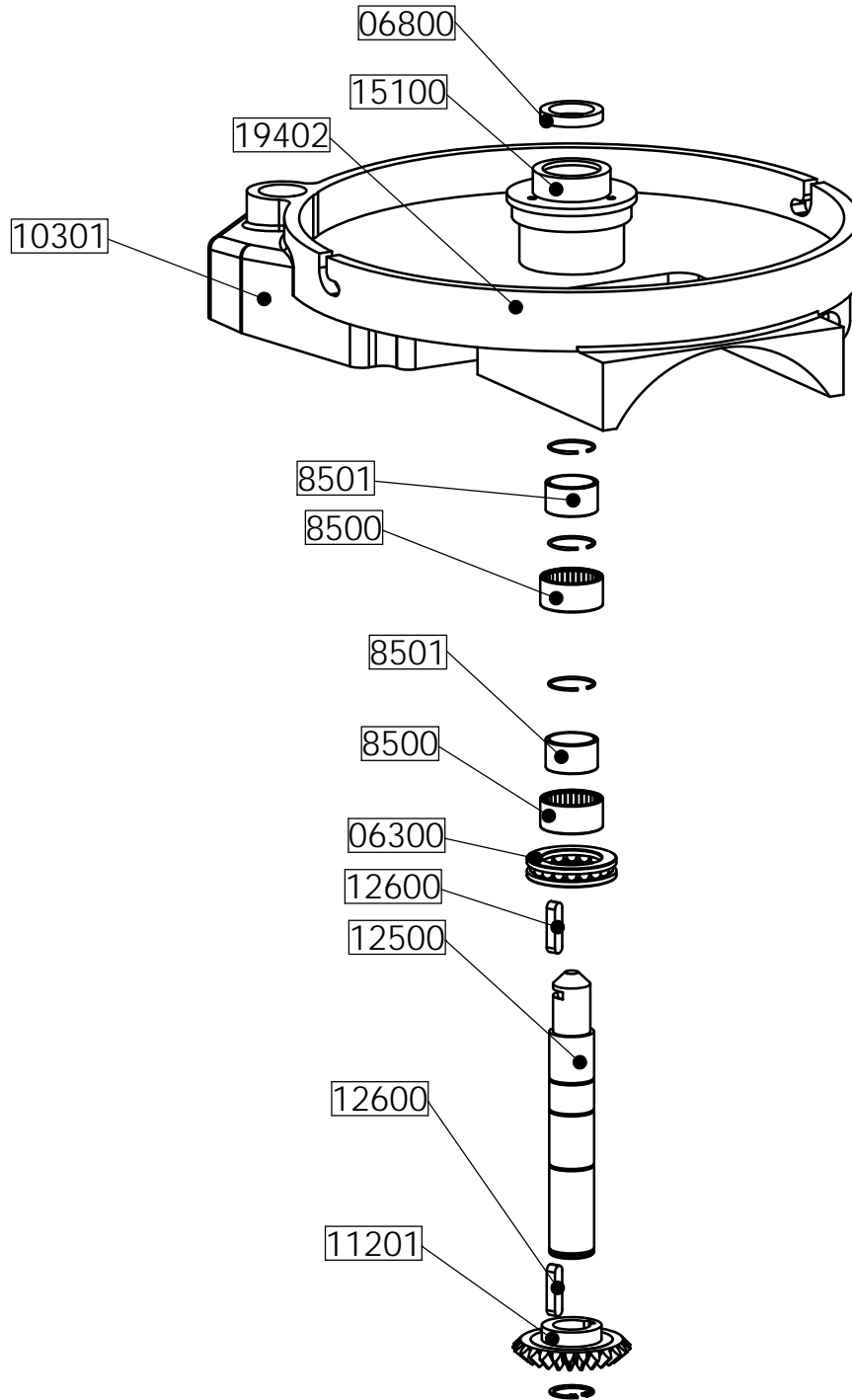

| CODE     | DESCRIZIONE ARTICOLO                                    | DESCRIPTION                  | Q.TY |
|----------|---|------------------------------|------|
| F9306300 | CUSCIN.51108 40x60x13                                   | BEARING 51108 40x60x13       | 1    |
| F9306800 | ANELLO TEN. AS 30x42x7 NBR                              | SEAL AS 30x42x7 NBR          | 2    |
| F9308300 | CATENA RCX P.8 semp.ISO 9001 L=568 (570)                | CHAIN P.8 ISO 9001           | 1    |
| F9308500 | BOCC.a RULL.36x42x20 HK3520 ordinare+ANELLO IR 30x35x20 | BUSHING 36x42x20 HK3520      | 1    |
| F9308501 | ANELLO IR 30x35x20xBOCC.HK3520                          | RING IR 30x35x20xBOCC.HK3520 | 1    |
| F9310301 | CUPOLA F93 #  | HOPPER PLATE                 | 1    |
| F9311201 | INGRAN.CONICO 25x28,2 M 3 Z=25                          | CONIC GEAR 25x28,2 M3 Z=25   | 1    |
| F9312500 | ALBERO RACLA d30x195                                    | PADDLE SHAFT d30x195         | 1    |
| F9312600 | LINGUETTA 8x8x45 INOX 316 Tipo A non unificato con foro | KEY 8x8x45                   | 1    |
| F9315100 | BOCC.87x33,5 Alluminio                                  | ALU BUSHING 87x33,5          | 1    |
| F9319402 | ANELLO OR 69.3 x 5.7 NBR                                | O RING 69,3x5,7              | 1    |



**ABM**  
**F2000N - F3000N - F4000N - B1200N**  
**NSF / ETL VERSION**  
**FROM SERIAL NUMBER: 3153**

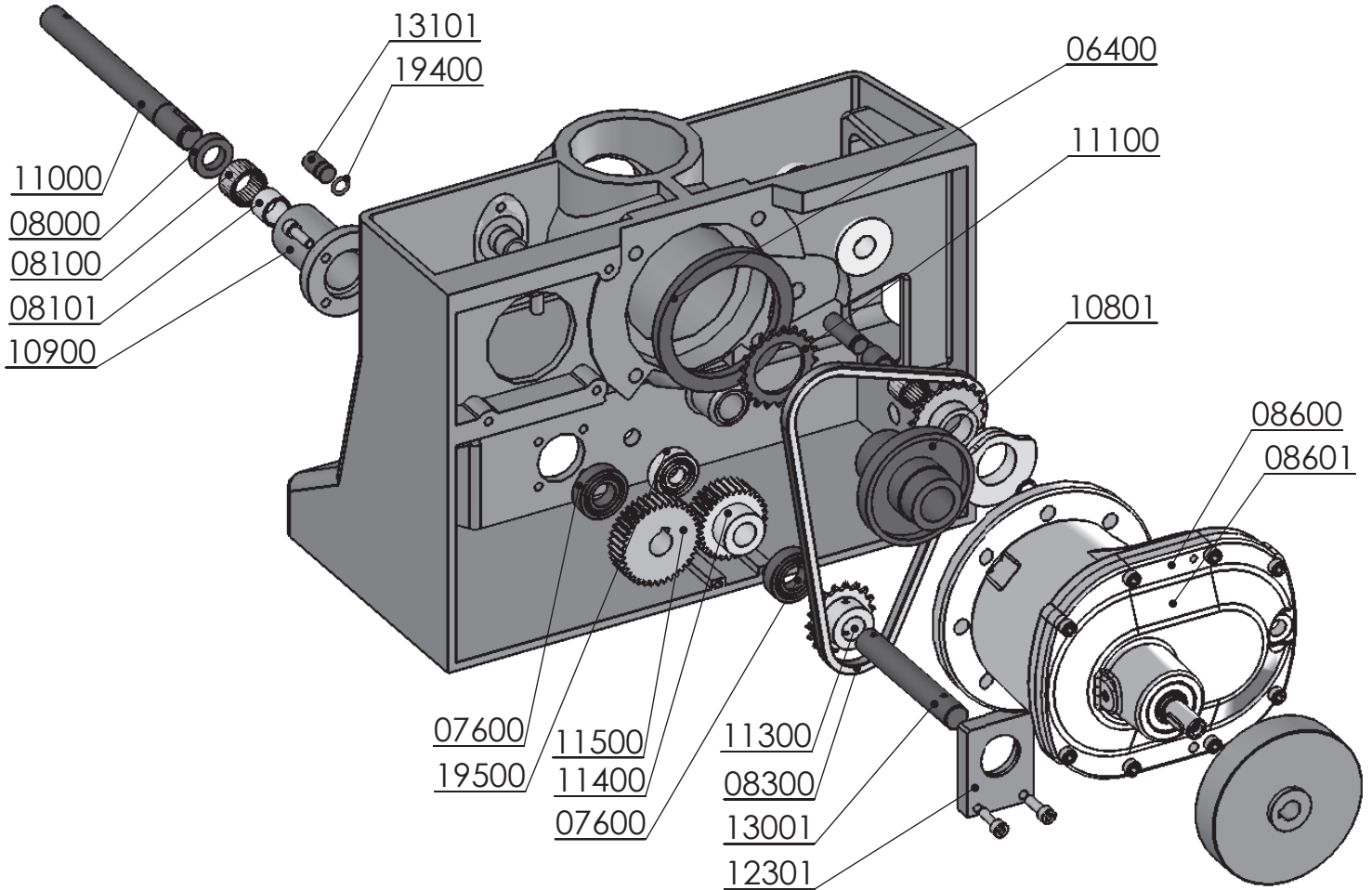

| CODE     | DESCRIPTION                     | Q.TY |
|----------|---------------------------------|------|
| F9306400 | RING 80x100x10                  | 1    |
| F9307600 | BEARING 6003 2RS 17x35x10       | 2    |
| F9308000 | SEAL 17x28x7 NBR                | 1    |
| F9308100 | BUSHING 1720x16 NK20/16         | 1    |
| F9308101 | RING 17x20x16                   | 1    |
| F9308300 | CHAIN P8 ISO 9001               | 1    |
| F9308600 | GEAR BOX RC 220 B5 1:30         | 1    |
| F9308601 | GEAR BOX RC 220 B5 1:46 - B1200 | 1    |
| F9310801 | GEAR 80x66                      | 1    |
| F9310900 | CONVEYOR SHAFT SUPPORT 60x67    | 1    |
| F9311000 | SHAFT 17 x 179                  | 1    |
| F9311100 | CHAIN PINION 8x3 Z=21           | 1    |
| F9311300 | CHAIN PINION 8x3 Z=18           | 1    |
| F9311400 | RELEASE GEAR M 1,5 Z=32         | 1    |
| F9311500 | GEAR M 1,5 Z=38                 | 1    |
| F9312301 | RELEASE SUPPORT                 | 1    |
| F9313001 | RELEASE SHAFT 17x115            | 1    |
| F9313101 | RELEASE PIN                     | 1    |
| F9319400 | O RING 9,25x1,78                | 1    |
| F9319500 | BEARING 6201 2RS 12x32x10       | 1    |



**ABM**  
**F2000N - F3000N - F4000N - B1200N**  
**NSF / ETL VERSION**  
**FROM SERIAL NUMBER: 3153**

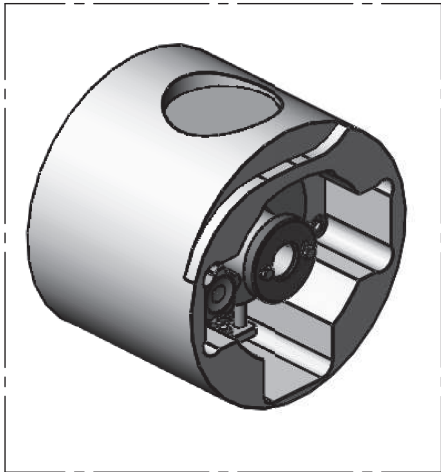
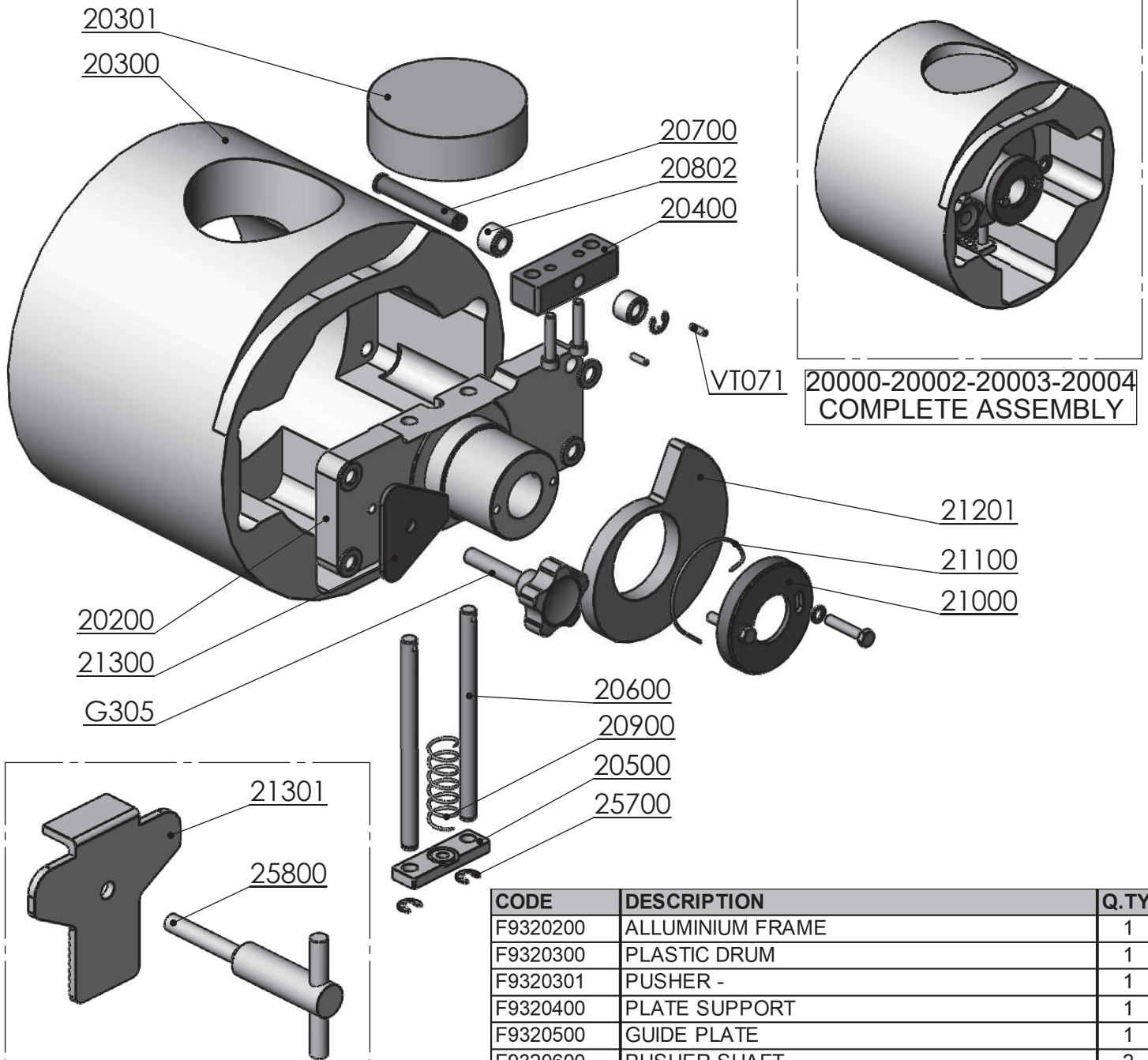

**20000-20002-20003-20004**  
**COMPLETE ASSEMBLY**

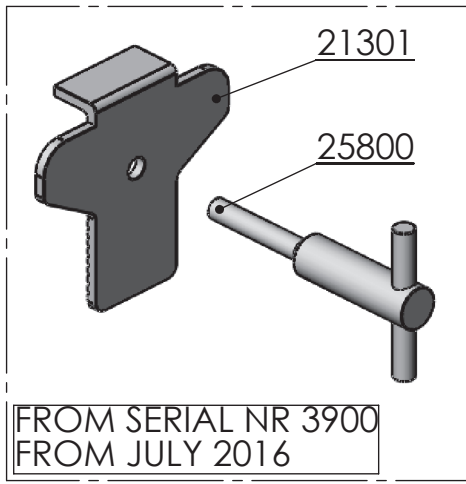

**FROM SERIAL NR 3900**  
**FROM JULY 2016**

| CODE     | DESCRIPTION                        | Q.TY |
|----------|------------------------------------|------|
| F9320200 | ALLUMINIUM FRAME                   | 1    |
| F9320300 | PLASTIC DRUM                       | 1    |
| F9320301 | PUSHER -                           | 1    |
| F9320400 | PLATE SUPPORT                      | 1    |
| F9320500 | GUIDE PLATE                        | 1    |
| F9320600 | PUSHER SHAFT                       | 2    |
| F9320700 | PIN 8X56,5                         | 1    |
| F9320802 | PLASTIC BEARING d.20               | 2    |
| F9320900 | PUSHER SPRING                      | 1    |
| F9321000 | LOCKING MECHANISM                  | 1    |
| F9321100 | LOCKING MECHANISM SPRING           | 1    |
| F9321201 | THICKNESS CAM                      | 1    |
| F9321300 | LOCKING THICKNESS MECHANISM        | 1    |
| F9321301 | LOCKING THICKNESS MECHANISM        | 1    |
| F9325700 | RING . d 8 UNI 7435                | 2    |
| F9325800 | DRUM SHAFT BUTTERFLY               | 1    |
| G305     | PLASTIC KNOB - D3 6G               | 1    |
| VT071    | ROLL PIN M3x20 SS                  | 2    |
| CODE     | COMPLETE ASSEMBLY                  | Q.TY |
| F9320000 | DRUM SINGLE SHAPE ON REQUEST       | 1    |
| F9320002 | DRUM DOUBLE SHAPE ON REQUEST       | 1    |
| F9320003 | DRUM FOUR SHAPE ON REQUEST         | 1    |
| F9320004 | DRUM COOKIE ALU - SHAPE ON REQUEST | 1    |





**ABM**  
**F2000N - F3000N - F4000N - B1200N**  
**NSF / ETL VERSION**  
**FROM SERIAL NUMBER: 3153**

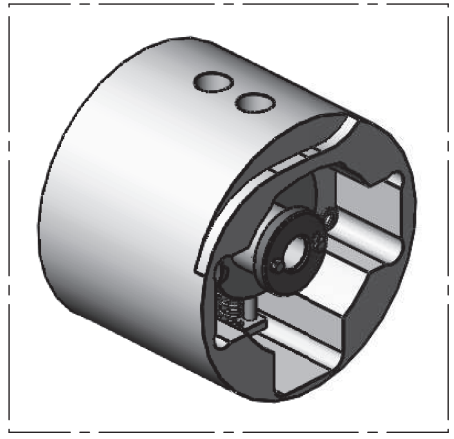
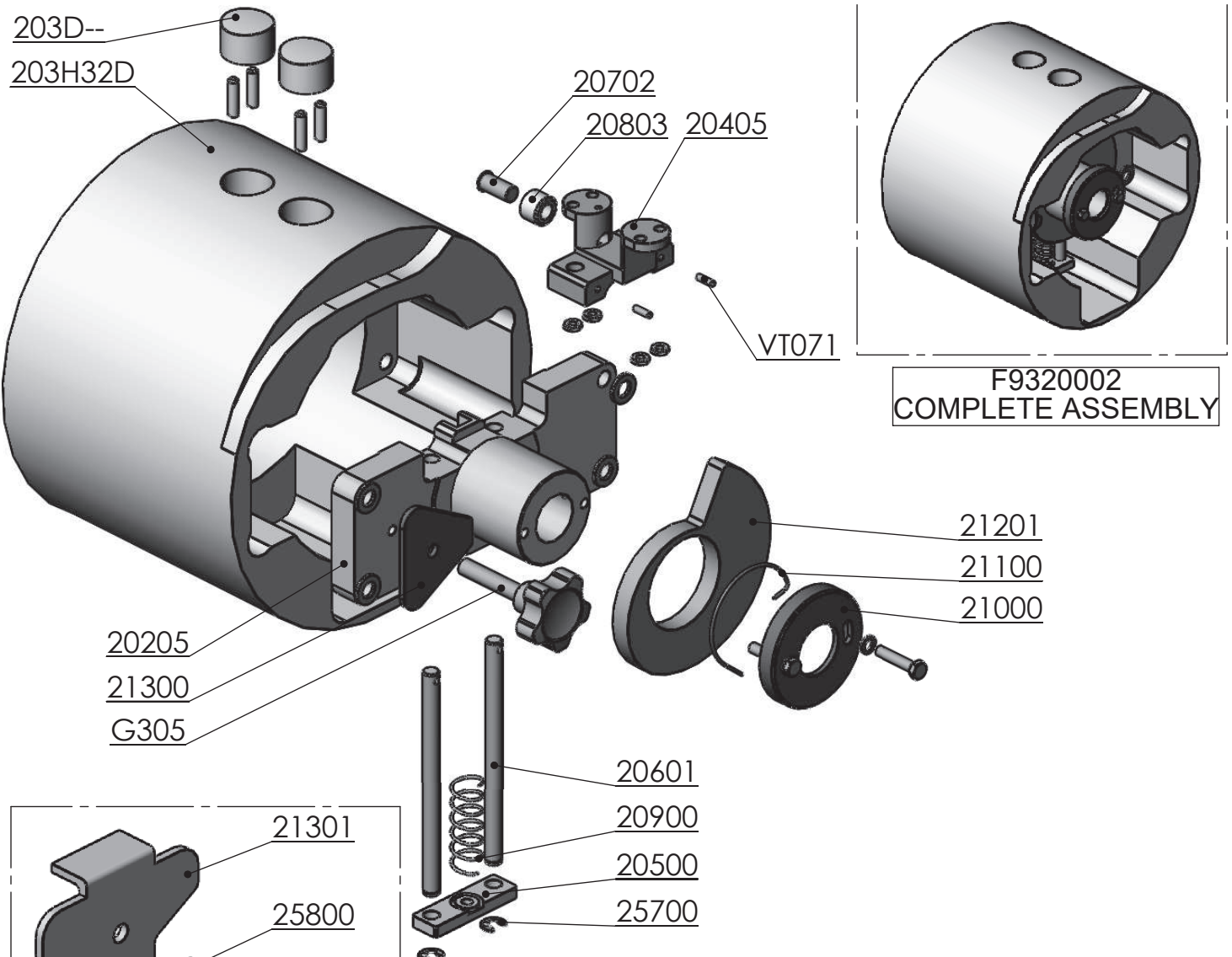

**F9320002**  
**COMPLETE ASSEMBLY**

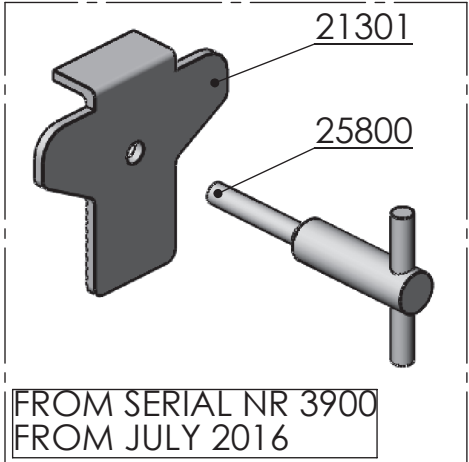

| CODE            | DESCRIPTION                               | Q.TY        |
|-----------------|---|-------------|
| F9320205        | ALLUMINIUM FRAME                          | 1           |
| F93203D--       | PUSHER D25 -D28 -D30 -D35- D40 -D43       | 1           |
| F93203H32D--    | PLASTIC DRUM D25 -D28 -D30 -D35 -D40 -D43 | 1           |
| F9320405        | PLATE SUPPORT                             | 1           |
| F9320500        | GUIDE PLATE                               | 1           |
| F9320601        | PUSHER SHAFT                              | 2           |
| F9320702        | PIN 8X19                                  | 1           |
| F9320803        | PLASTIC BEARING d.14,5                    | 1           |
| F9320900        | PUSHER SPRING                             | 1           |
| F9321000        | LOCKING MECHANISM                         | 1           |
| F9321100        | LOCKING MECHANISM SPRING                  | 1           |
| F9321201        | THICKNESS CAM                             | 1           |
| F9321300        | LOCKING THICKNESS MECHANISM               | 1           |
| F9321301        | LOCKING THICKNESS MECHANISM               | 1           |
| F9325700        | RING . d 8 UNI 7435                       | 2           |
| F9325800        | DRUM SHAFT BUTTERFLY                      | 1           |
| G305            | PLASTIC KNOB - D3 6G                      | 1           |
| VT071           | ROLL PIN M3x20 SS                         | 2           |
| <b>CODE</b>     | <b>COMPLETE ASSEMBLY</b>                  | <b>Q.TY</b> |
| <b>F9320002</b> | <b>DRUM DOUBLE SHAPE ON REQUEST</b>       | <b>1</b>    |



**ABM**  
**F2000N - F3000N - F4000N - B1200N**  
**NSF / ETL VERSION**  
**FROM SERIAL NUMBER: 3153**

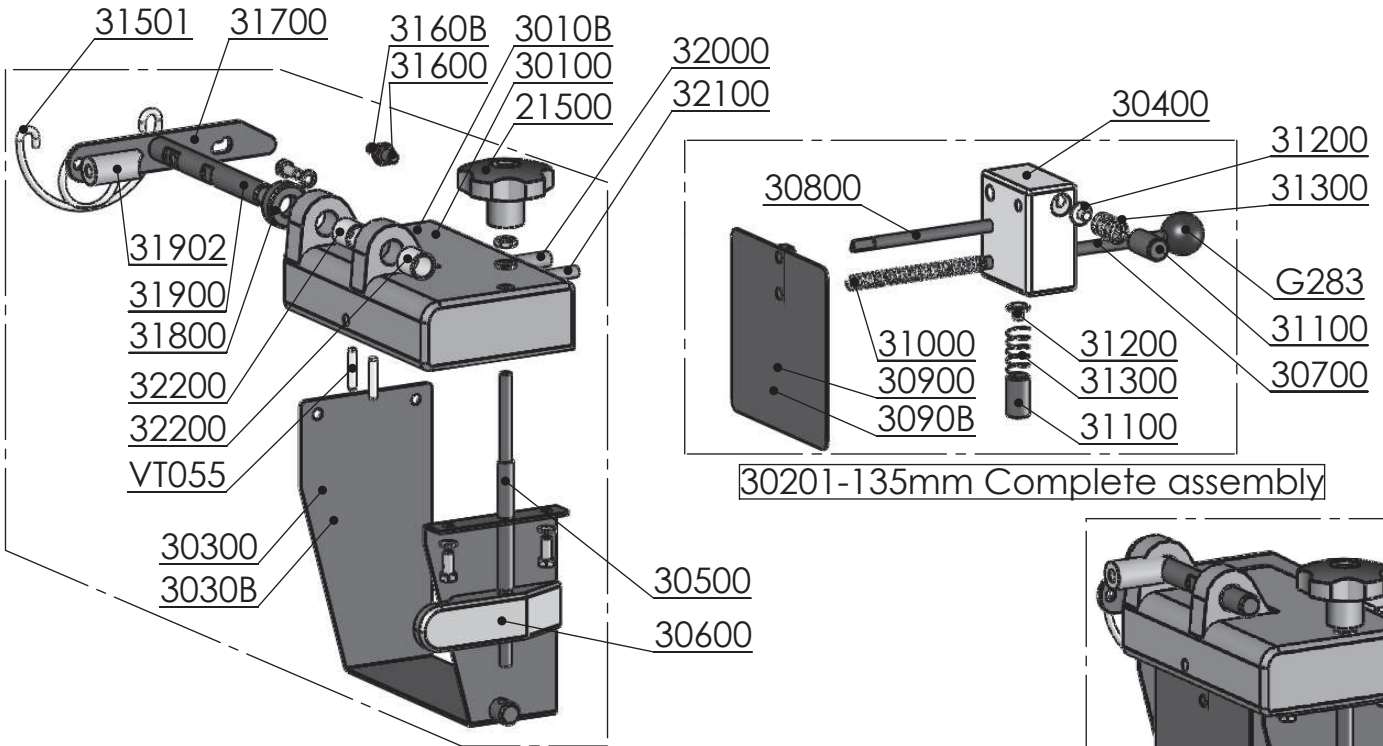

30202-135mm Complete assembly

30201-135mm Complete assembly

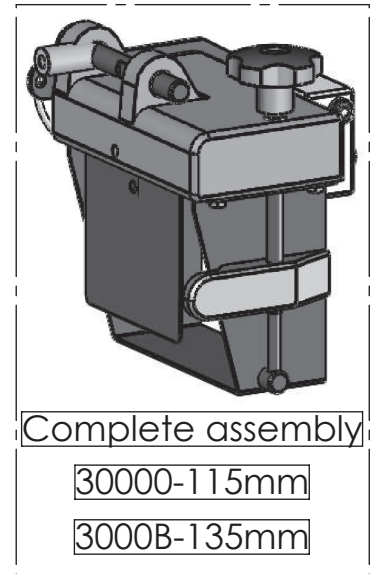

| CODE     | DESCRIPTION                          | Q.TY |
|----------|--------------------------------------|------|
| F9330400 | PAPER HOUSING                        | 1    |
| F9321500 | PLASTIC KNOB - D3 6G                 | 1    |
| F9330100 | ALU PAPER ATTACH HOLDER 115mm        | 1    |
| F933010B | ALU PAPER ATTACH HOLDER 135mm        | 1    |
| F9330300 | PAPER MAGAZINE 115mm                 | 1    |
| F933030B | PAPER MAGAZINE 135mm                 | 1    |
| F9330500 | SCREW 6x160                          | 1    |
| F9330600 | CAM                                  | 1    |
| F9330700 | GUIDING PIN 6x117                    | 1    |
| F9330800 | PIN                                  | 1    |
| F9330900 | PAPER PUSHER 115mm                   | 1    |
| F933090B | PAPER PUSHER 135mm                   | 1    |
| F9331000 | PAPER PUSHER SPRING                  | 1    |
| F9331100 | LOCKING PAPER PIN                    | 2    |
| F9331200 | PIN 12x7,5                           | 2    |
| F9331300 | SPRING 05 DE 11                      | 2    |
| F9331400 | BUSHING 8x7,5                        | 1    |
| F9331500 | SPRING d 10 L 55                     | 1    |
| F9331600 | SRING PIN 115mm PAPER ATT.           | 1    |
| F933160B | SRING PIN 135mm PAPER ATT.           | 1    |
| F9331700 | RELEASE LEVER                        | 1    |
| F9331800 | STOPPING SEAL                        | 1    |
| F9331900 | PAPER ATTACHMENT SUPPORT PIN         | 1    |
| F9331902 | PAPER ATTACHMENT SUPPORT PIN SUPPORT | 1    |
| F9332000 | GUIDING PIN 8x55                     | 1    |
| F9332100 | GUIDING PIN 6x48                     | 1    |
| F9332200 | BUSHING 12x14x15                     | 2    |
| G283     | KNOB                                 | 1    |
| VT055    | PARALLEL PIN M4x24 SS                | 2    |
| CODE     | COMPLETE ASSEMBLY                    | Q.TY |
| F9330000 | PAPER ATTACHMENT COMPLETE            | 1    |
| F933000B | PAPER ATTACH. COMPLETE 135mm         | 1    |
| F9330201 | PAPER PUSHER ASSEMBLY                | 1    |
| F9330202 | PAPER SUPPORT ASSEMBLY               | 1    |





**ABM**  
**F2000N - F3000N - F4000N - B1200N**  
**NSF / ETL VERSION**  
**FROM SERIAL NUMBER: 3153**

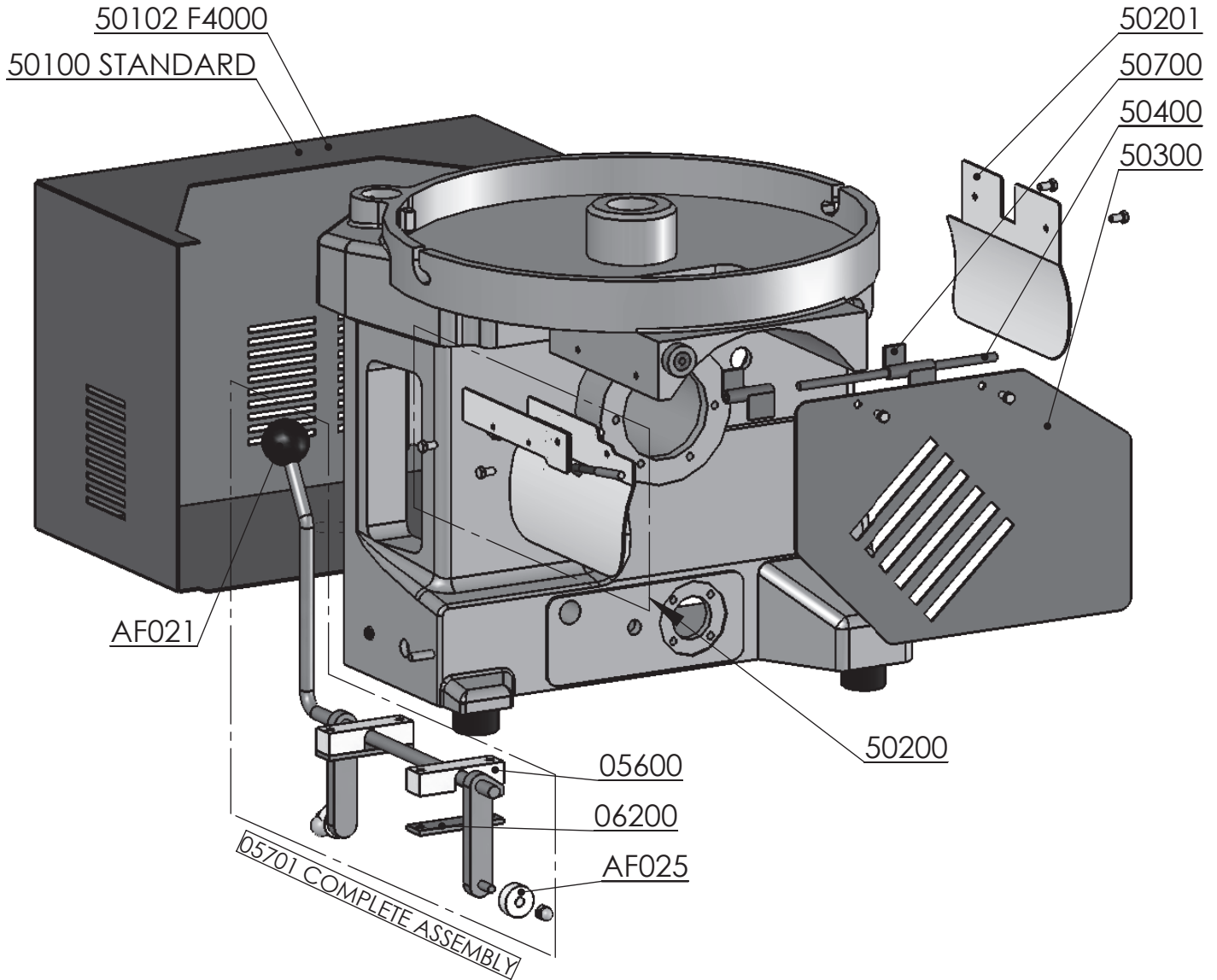

| CODE            | DESCRIPTION                               | Q, TY    |
|-----------------|---|----------|
| AF021           | KNOB Ø40 M10                              | 1        |
| AF025           | PTFE WHEEL                                | 2        |
| F9305600        | GUIDE                                     | 2        |
| F9306200        | METAL PLATE                               | 2        |
| F9350100        | SS REAR PROTECTION                        | 1        |
| F9350102        | REAR PROTECTION F4000                     | 1        |
| F9350200        | LEFT SIDE PROTECTION                      | 1        |
| F9350201        | RIGHT SIDE PROTECTION                     | 1        |
| F9350300        | SS DRUM PROTECTION 205x300                | 1        |
| F9350400        | LOCKING KEY PIN 8x177 M4                  | 1        |
| F9350700        | LOCKING LEFT AND RIGHT KEY                | 1        |
| CODE            | DESCRIPTION                               | Q, TY    |
| <b>F9305701</b> | <b>TILTING DEVICE - COMPLETE ASSEMBLY</b> | <b>1</b> |



**ABM**  
**F2000N - F3000N - F4000N - B1200N**  
**NSF / ETL VERSION**  
**FROM SERIAL NUMBER: 3153**

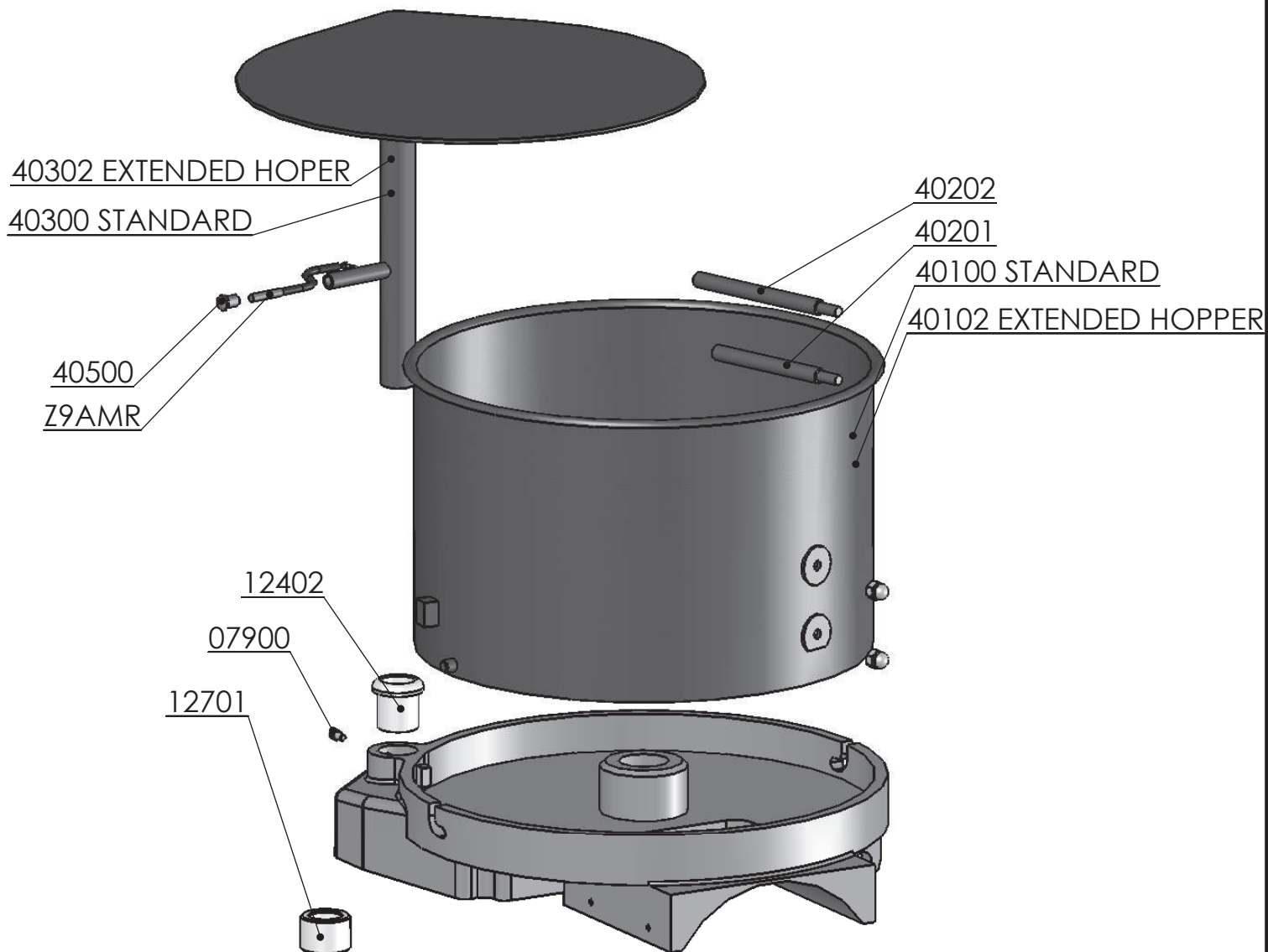

FINO ALLA DATA 5 FEB 2018  
 UNTIL DATE 2018 FEB

| CODE     | DESCRIPTION             | Q, TY |
|----------|-------------------------|-------|
| F9307900 | SCREW                   | 1     |
| F9312402 | BUSHING                 | 1     |
| F9312701 | BUSHING                 | 1     |
| F9340100 | HOPPER d360x260h        | 1     |
| F9340102 | HOPPER d360x430h        | 1     |
| F9340201 | HOPPER SHORT PIN 12x110 | 1     |
| F9340202 | HOPPER LONG PIN 12x130  | 1     |
| F9340300 | HOPPER COVER ARM        | 1     |
| F9340302 | EXT.HOPPER COVER ARM    | 1     |
| F9340500 | MAGNET SUPPORT          | 1     |
| Z9AMR    | SAFETY CONTACT D6       | 1     |



**ABM**  
**F2000N - F3000N - F4000N - B1200N**  
**NSF / ETL VERSION**  
**FROM SERIAL NUMBER: 3153**

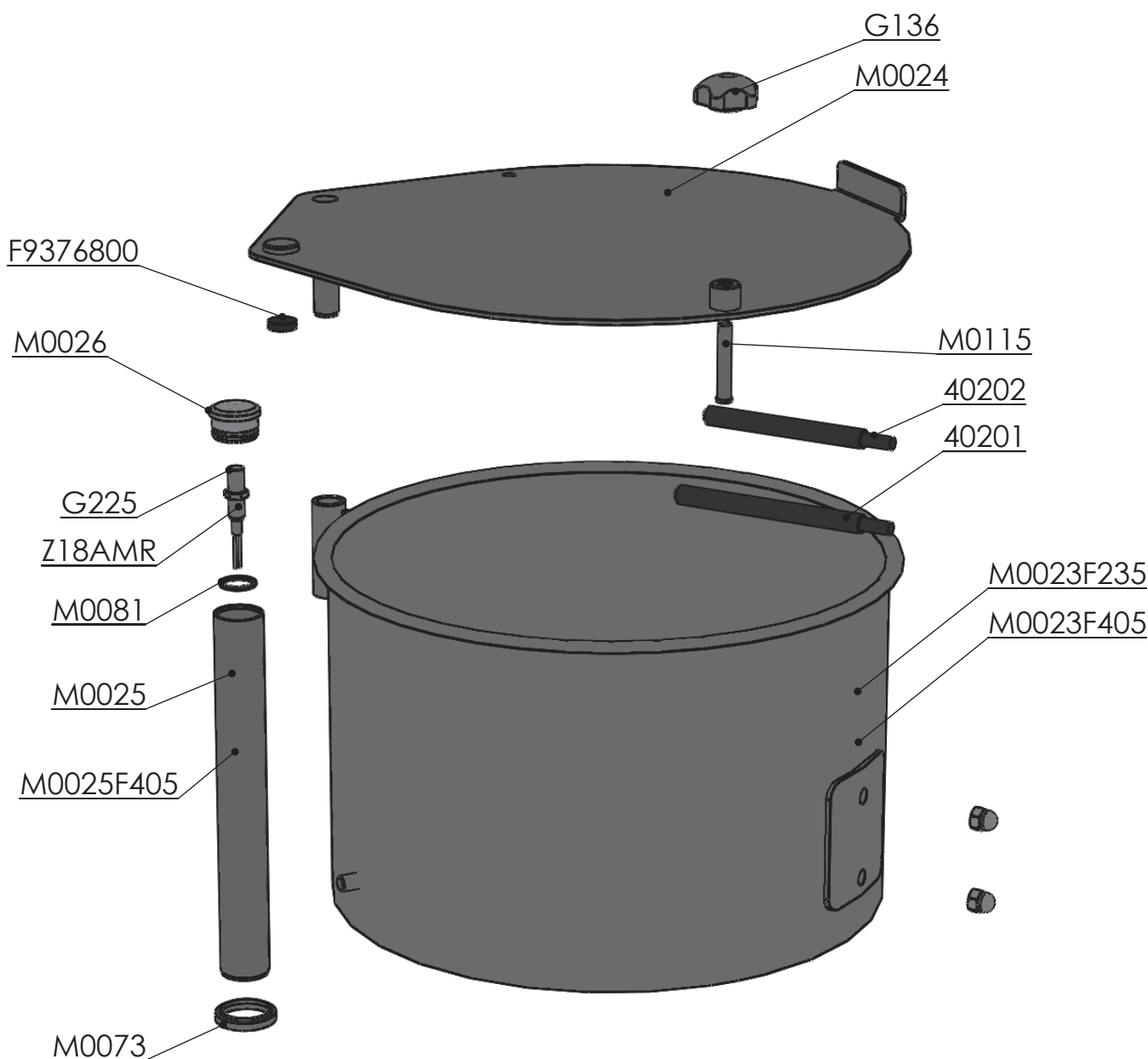

**NUOVO CONTENITORE, COPERCHIO E SENSORE**  
**NEW HOPPER, HOPPER COVER AND SENSOR**

**DALLA DATA 5 FEB 2018**  
**FROM DATE 2018 FEB 5**

| CODE      | DESCRIPTION             | Q, TY |
|-----------|-------------------------|-------|
| F9340201  | HOPPER SHORT PIN 12x110 | 1     |
| F9340202  | HOPPER LONG PIN 12x130  | 1     |
| F9376800  | MAGNET d.18             | 1     |
| G136      | ALU KNOB                | 1     |
| G225      | SENSOR M10x0.75         | 1     |
| M0023F235 | HOPPER 25 liters        | 1     |
| M0023F405 | HOPPER 40 liters        | 1     |
| M0024     | HOPPER COVER            | 1     |
| M0025     | PIPE OF THE SENSOR L250 | 1     |
| M0025F405 | PIPE OF THE SENSOR L420 | 1     |
| M0026     | SENSOR SEAT d. M10x0.75 | 1     |
| M0073     | SCRAPER RING            | 1     |
| M0081     | O-RING-INT. 23.8x2.62   | 1     |
| M0115     | STOP COVER PIN          | 1     |
| Z18AMR    | SAFETY SENSOR 2NA / 2NO | 1     |



**ABM**  
**F2000N - F3000N - F4000N - B1200N**  
**NSF / ETL VERSION**  
**FROM SERIAL NUMBER: 3153**

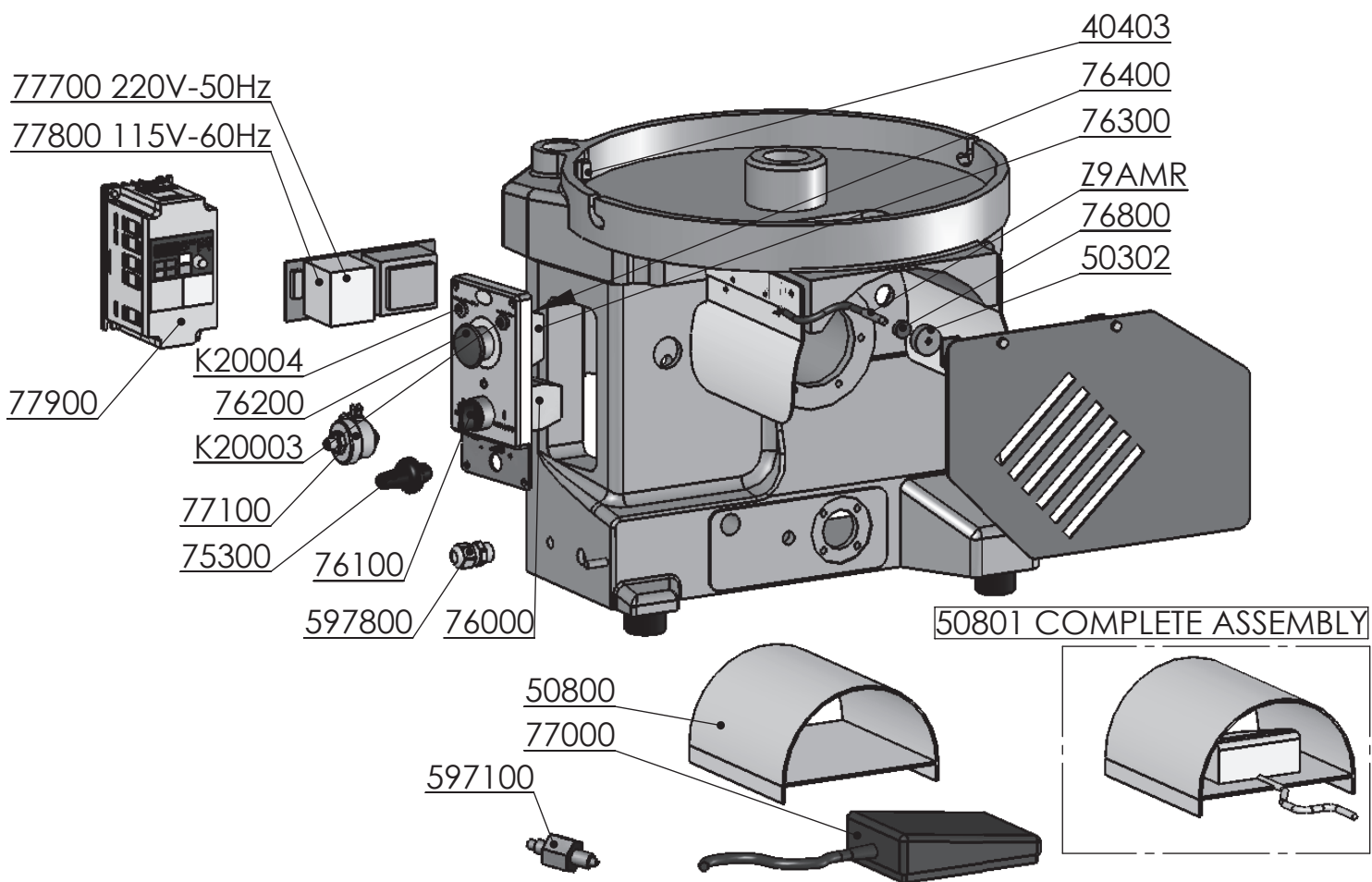

| CODE     | DESCRIPTION  | Q.TY |
|----------|--|------|
| F934043  | CERAMIC MAGNET 16x9, 5x8                                   | 1    |
| F9350302 | MAGNET HOLDER  | 1    |
| F9350800 | PNEUM. FOOTSWITCH SUP. PROTEC.                             | 1    |
| F9375300 | POTENTIOMETER F4000 R10K1 M22 MOELLER                      | 1    |
| F9376000 | DOUBLE SWITCH  | 1    |
| F9376100 | HAND/FOOT SWITCH   | 1    |
| F9376200 | STOP BUTTON  | 1    |
| F9376300 | SWITCH 1 NC SCREW  | 1    |
| F9376400 | SWITCH 1 NO SCREW  | 1    |
| F9376800 | MAGNET   | 1    |
| F9377000 | FOOTSWITCH 6210-OB   | 1    |
| F9377100 | PNEUM. SWITCH MOM.6871-01                                  | 1    |
| 597100   | MALE COUPLING BODY   | 1    |
| 597800   | FEMALE COUPLING BODY                                       | 1    |
| F9377900 | INVERTER SYN10 S 220 05 AF IP65 S 50/60H Kw. 0,75 115/220V | 1    |
| K20003   | RED LAMP   | 1    |
| K20004   | GREEN LAMP   | 1    |
| F9377700 | CARD 220/50 HZ START STOP FROM SN. 1710                    | 1    |
| F9377800 | CARD 115/60 HZ START STOP FROM SN. 1710                    | 1    |
| Z9AMR    | SAFETY CONTACT Ø6  | 1    |
| CODE     | DESCRIPTION  | Q.TY |
| F9350801 | FOOT SWITCH - COMPLETE ASSEMBLY                            | 1    |



**ABM**  
**F2000N - F3000N - F4000N - B1200N**  
**NSF / ETL VERSION**  
**FROM SERIAL NUMBER: 3153**

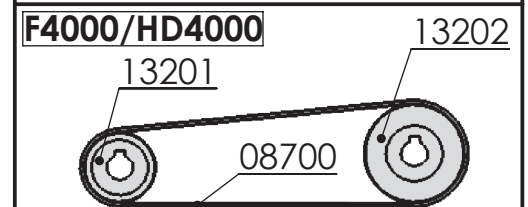
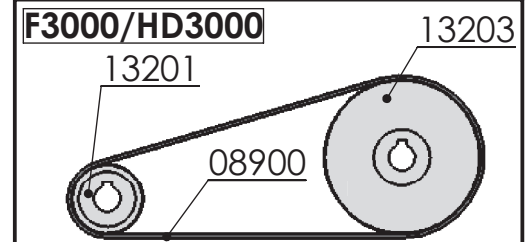
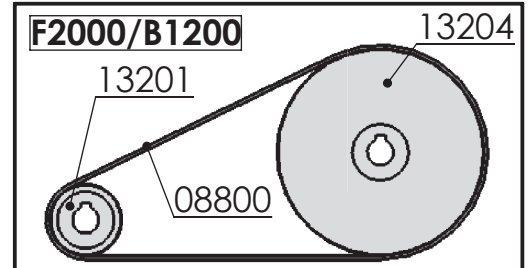
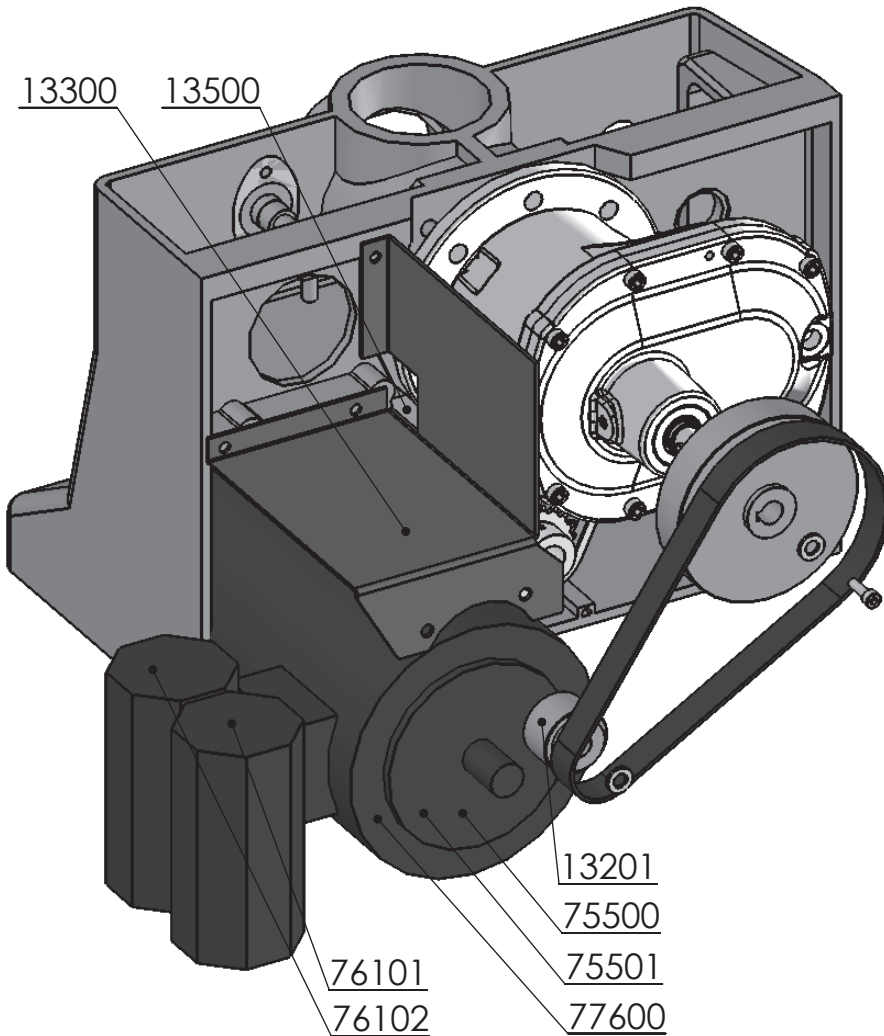

| CODE     | DESCRIPTION  | Q. TY |
|----------|--|-------|
| F9308700 | BELT - F 4000 / HD 4000 - PJ 457 J8                      | 1     |
| F9308800 | BELT - F 2000 / B 1200 - PJ 559 J8 220 mm                | 1     |
| F9308900 | BELT - F 3000 / HD 3000 - PJ508                          | 1     |
| F9313201 | MOTOR PULLEY 38 x 31- ALL                                | 1     |
| F9313202 | GEAR PULLEY 53 x 31 - F 4000                             | 1     |
| F9313203 | GEAR PULLEY - F 3000 HD 3000 83 x 31                     | 1     |
| F9313204 | GEAR PULLEY - F 2000 110 x 31                            | 1     |
| F9313300 | MOTOR SUPPORT  | 1     |
| F9313500 | MOTOR SPRING TENS  | 1     |
| F9375500 | MOTOR - LMR 71 230 V. 50 Hz F 2 - 3 - HD 3000 - B 1200   | 1     |
| F9375501 | MOTOR - LMR 71 115 V. 60 Hz F 2 - 3 - HD 3000 - B 1200   | 1     |
| F9376101 | MOTOR CAPACITOR BLACK 31,5 - 40 mf VLCA 280 40 : 60      | 1     |
| F9376102 | MOTOR F 2-3- B 1200 CAPACITOR WHITE                      | 1     |
| F9377600 | MOTOR THREE PHASE F 4000 only 0,55 Kw 230/400 V 50Hz B14 | 1     |



**F2000N - F3000N - F4000N - B1200N  
NSF / ETL  
MANUAL VERSION  
FROM SERIAL NUMBER: 3153**

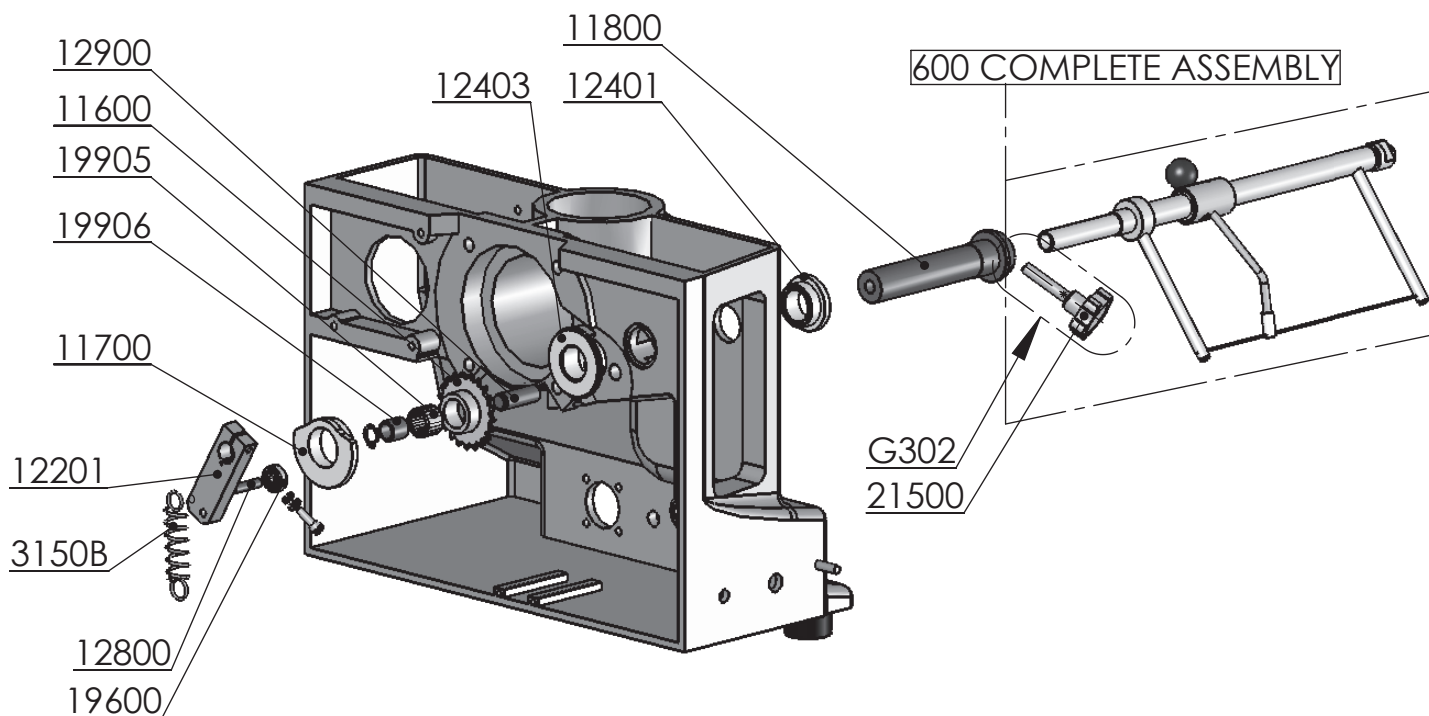

| CODE     | DESCRIPTION                      | Q.TY |
|----------|----------------------------------|------|
| F9311600 | CAM PINION 8x3 Z=21              | 1    |
| F9311700 | SCRAPER CAM                      | 1    |
| F9311800 | SLIDING SUPPORT                  | 1    |
| F9312201 | SCRAPER CONTROL LEVER            | 1    |
| F9312401 | FRONT BUSHING 40x16 ERTALON      | 1    |
| F9312403 | REAR BUSHING                     | 1    |
| F9312800 | PULLEY PIN 6x30                  | 1    |
| F9312900 | CAM PIN 12x37                    | 1    |
| F9319600 | BEARING 626 2RS 6x19x6           | 1    |
| F9319905 | BUSHING 12x21x16                 | 1    |
| F9319906 | PNEUMATIC SCRAPER SHAFT          | 1    |
| F9321500 | KNOB                             | 1    |
| F933150B | SCRAPER SPRING                   | 1    |
| CODE     | DESCRIPTION                      | Q.TY |
| F93G302  | WIRE CLEANER LOCKER ASSEMBLY     | 1    |
| F93600   | COMPLETE MANUAL CLEANER ASSEMBLY | 1    |





**F2000N - F3000N - F4000N - B1200N  
NSF / ETL  
PNEUMATIC VERSION  
FROM SERIAL NUMBER: 3153**

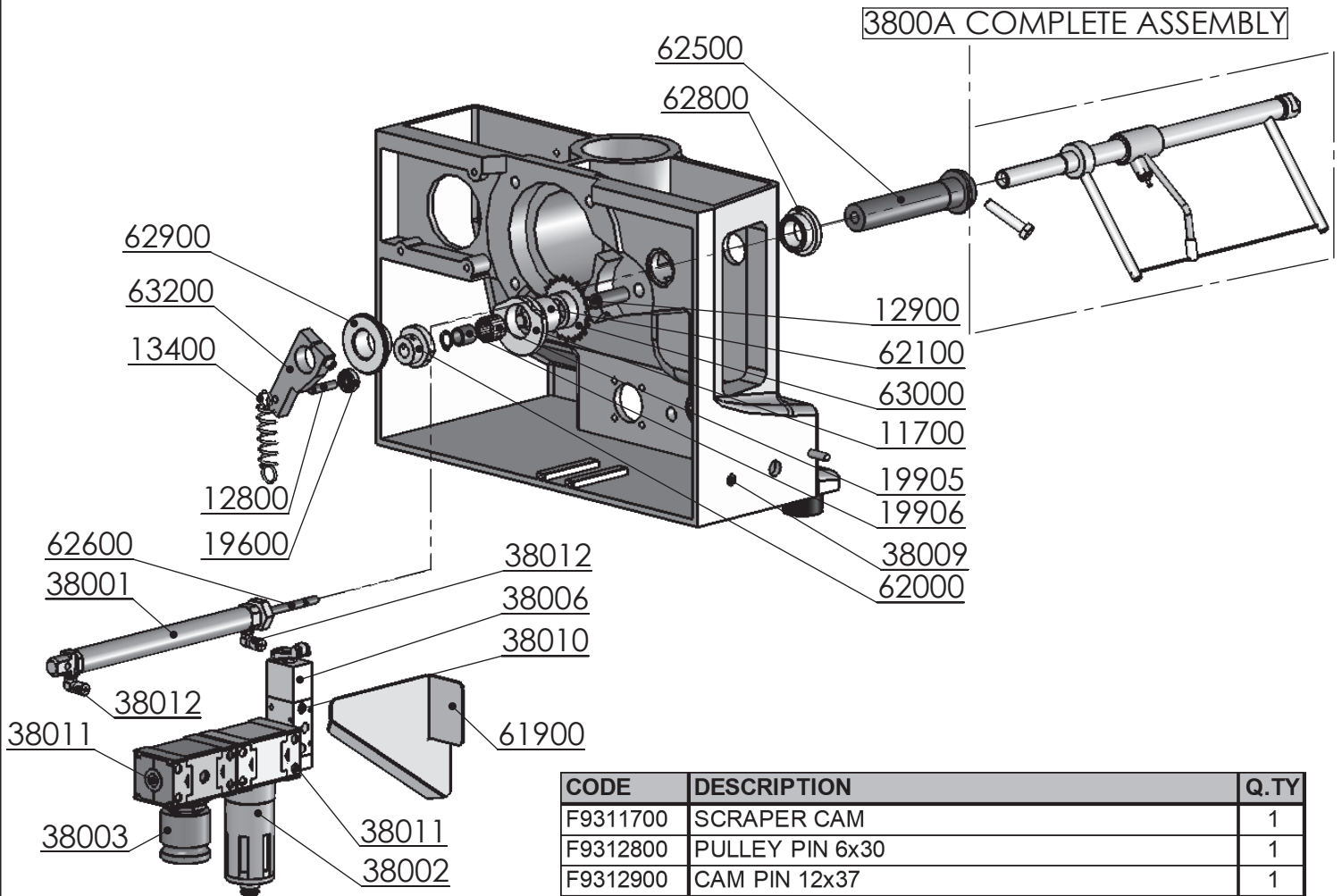

**3800A COMPLETE ASSEMBLY**

| CODE            | DESCRIPTION                                | Q.TY     |
|-----------------|--|----------|
| F9311700        | SCRAPER CAM                                | 1        |
| F9312800        | PULLEY PIN 6x30                            | 1        |
| F9312900        | CAM PIN 12x37                              | 1        |
| F9313400        | CLEANER SPRING                             | 1        |
| F9319600        | BEARING 626 2RS 6x19x6                     | 1        |
| F9319905        | BUSHING 12x21x16                           | 1        |
| F9338001        | CILINDER - ISO 6432                        | 1        |
| F9338002        | AIR FILTER                                 | 1        |
| F9338003        | FIL BIT 1/8 20 RMSA                        | 1        |
| F9338006        | SWITCH                                     | 1        |
| F9338009        | PASS WALL                                  | 1        |
| F9338010        | SILENCER                                   | 1        |
| F9338011        | L FITTING 6-1/8                            | 2        |
| F9338012        | L FITTING 4-M5                             | 2        |
| F9361500        | PNEUMATIC SCRAPER SHAFT                    | 1        |
| F9361900        | FIXING PLATE PNEUMATIC GROUP               | 1        |
| F9362000        | CYLINDER CAM                               | 1        |
| F9362100        | CYLINDER CAM SHAFT                         | 1        |
| F9362500        | OSCILLATING SUPPORT                        | 1        |
| F9362600        | PNEUMATIC PISTON                           | 1        |
| F9362800        | FRONT BUSHING                              | 1        |
| F9362900        | REAR BUSHING                               | 1        |
| F9363000        | CAM PINION 8x3 Z21 D26                     | 1        |
| F9363200        | SCRAPER CONTROL LEVEL                      | 1        |
| CODE            | DESCRIPTION                                | Q.TY     |
| <b>F933800A</b> | <b>COMPLETE PNEUMATIC CLEANER ASSEMBLY</b> | <b>1</b> |



F2000N - F3000N - F4000N - B1200N  
 NSF / ETL  
 PNEUMATIC VERSION  
 FROM SERIAL NUMBER: 3153



### 3800A COMPLETE ASSEMBLY

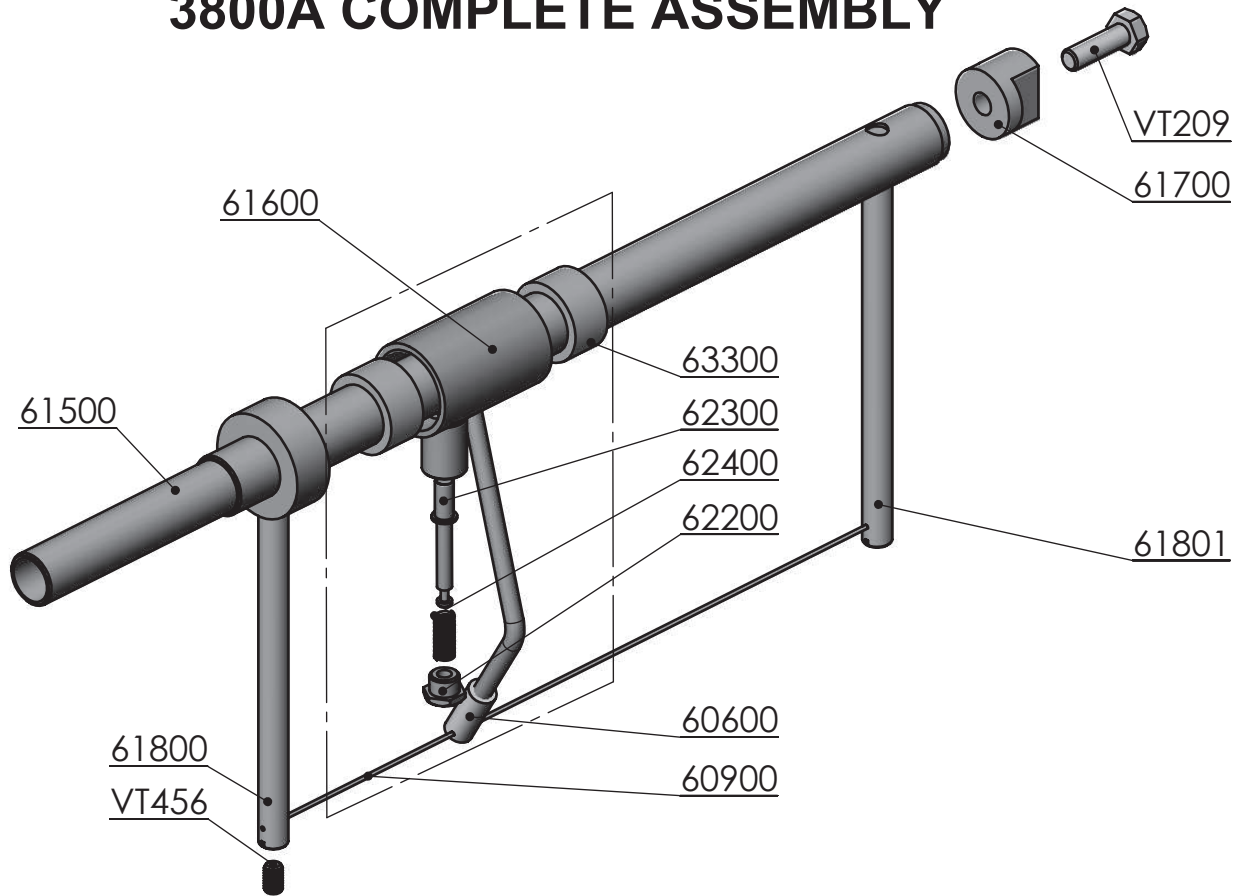

| CODE     | DESCRIPTION                                 | Q.TY |
|----------|---|------|
| F9363300 | BUSHING                                     | 2    |
| F9360600 | WIRE CLEANER NUT                            | 1    |
| F9360900 | S.S.WIRE                                    | 1    |
| F9361500 | PNEUMATIC SCRAPER SHAFT                     | 1    |
| F9361600 | WIRE CLEANER ARM                            | 1    |
| F9361700 | STRETCH WIRE NUT                            | 1    |
| F9361800 | REAR FIXED ROD                              | 1    |
| F9361801 | FRONT FIXED ROD                             | 1    |
| F9362200 | PIN BUSHING PNEU. SCRAPER                   | 1    |
| F9362300 | PIN 5x38 PNEUMATIC SCRAPER LOCKING          | 1    |
| F9362400 | PNEUMATIC SCRAPER SPRING                    | 1    |
| VT209    | HEX HEAD SCREW M6-1.0x20 SS                 | 1    |
| VT456    | HEX SOCKET SET SCREW FLAT POINT M5-0.8x8 SS | 1    |
| CODE     | DESCRIPTION                                 | Q.TY |
| F933800A | COMPLETE PNEUMATIC CLEANER ASSEMBLY         | 1    |
| F933800B | PNEUMATIC WIRE CLEANER ARM ASSEMBLY         | 1    |







0 1 2 3 4 5 6 7 8 9

A B C D E F

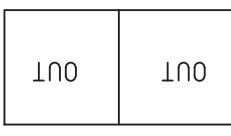
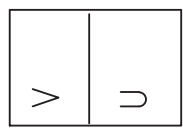
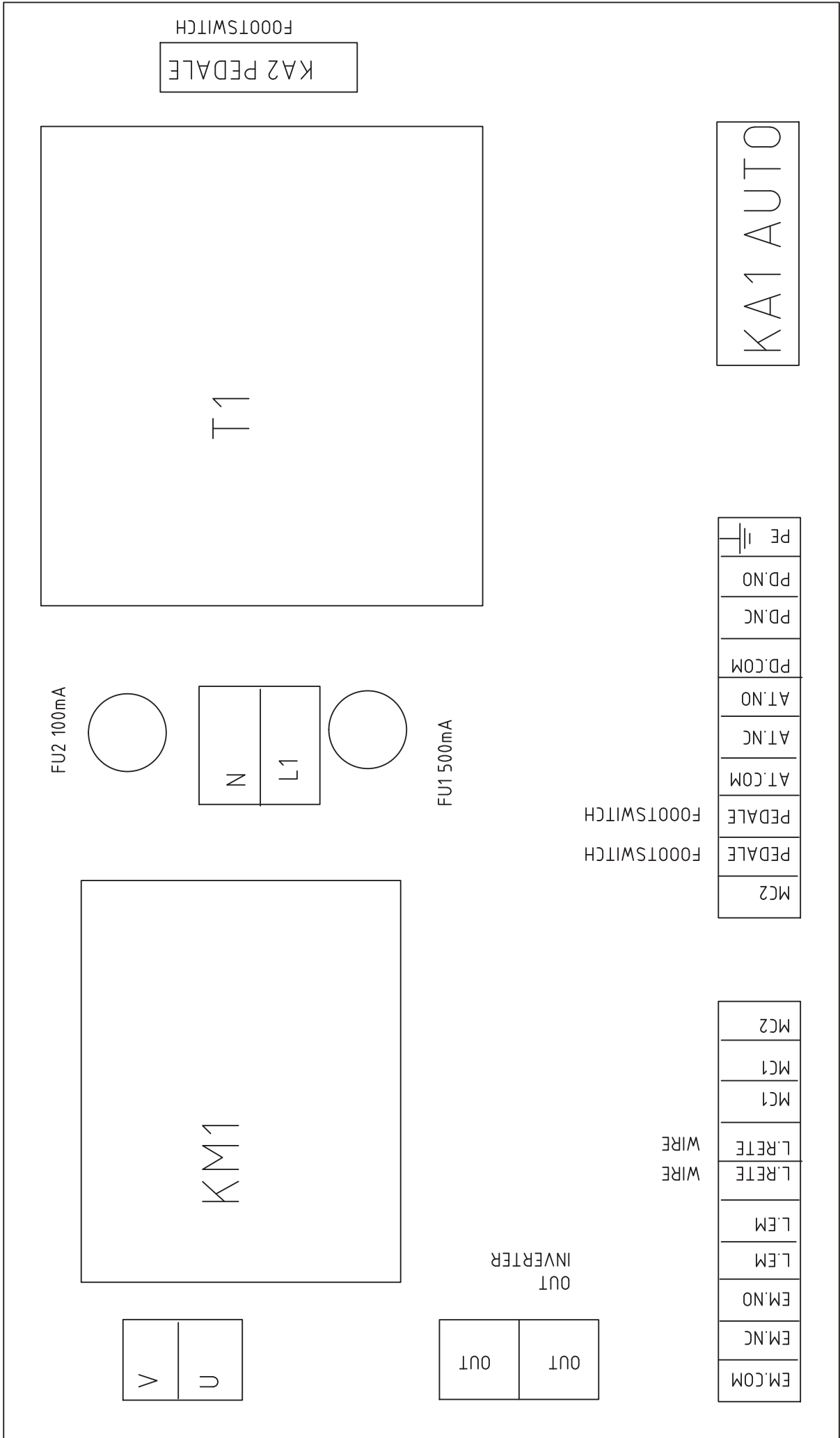

|        |       |       |      |        |      |        |
|--------|-------|-------|------|--------|------|--------|
| EM.COM | EM.NC | EM.NO | L.EM | L.RETE | WIRE | MC2    |
|        |       |       |      |        |      | MC1    |
|        |       |       |      |        |      | MC1    |
|        |       |       |      |        |      | L.RETE |
|        |       |       |      |        |      | L.RETE |
|        |       |       |      |        |      | WIRE   |

|     |        |        |              |              |        |       |       |        |       |       |    |
|-----|--------|--------|--------------|--------------|--------|-------|-------|--------|-------|-------|----|
| MC2 | PEDALE | PEDALE | F000T SWITCH | F000T SWITCH | AT.COM | AT.NC | AT.NO | PD.COM | PD.NC | PD.NO | PE |
|-----|--------|--------|--------------|--------------|--------|-------|-------|--------|-------|-------|----|

# ABM COMPANYSrl

|           |      |
|-----------|------|
| Dis. N.   |      |
| CAD       | SPAC |
| Nome File |      |
| Data      |      |

|               |             |
|---------------|-------------|
| Impianto      |             |
| Denominazione | TOPOGRAFICO |

|           |  |
|-----------|--|
| Ordine    |  |
| Commessa  |  |
| Esecutore |  |

|   |   |   |   |   |   |   |   |   |   |   |
|---|---|---|---|---|---|---|---|---|---|---|
|   | 0   | 1   | 2 | 3 | 4 | 5 | 6 | 7 | 8 | 9 |
| A | EM.COM COMUNE EMERGENZA<br>EM.NC CONTATTO NORMALMENTE CHIUSO EMERGENZA<br>EM.NO CONTATTO NORMALMENTE APERTO                     | EM.COM COMUNE EMERGENZA<br>EM.NC CONTATTO NORMALMENTE CHIUSO EMERGENZA<br>EM.NO CONTATTO NORMALMENTE APERTO                     |   |   |   |   |   |   |   |   |
| B | L.EM LAMPADA EMERGENZA<br>L.EM LAMPADA EMERGENZA<br>L.RETE LAMPADA RETE<br>L.RETE LAMPADA RETE                                  | L.EM LAMPADA EMERGENZA<br>L.EM LAMPADA EMERGENZA<br>L.RETE LAMPADA RETE<br>L.RETE LAMPADA RETE                                  |   |   |   |   |   |   |   |   |
| C | MC1 FINECORSIA 1<br>MC1 FINECORSIA 1<br>MC2 FINECORSIA 2<br>MC2 FINECORSIA 2<br>PEDALE PEDALE<br>PEDALE PEDALE                  | MC1 FINECORSIA 1<br>MC1 FINECORSIA 1<br>MC2 FINECORSIA 2<br>MC2 FINECORSIA 2<br>PEDALE PEDALE<br>PEDALE PEDALE                  |   |   |   |   |   |   |   |   |
| D | AT.COM SELETTORE AUTOMATICO COMUNE<br>AT, NC SELETTORE AUTOMATICO CONTATTO CHIUSO<br>AT.NO SELETTORE AUTOMATICO CONTATTO APERTO | AT.COM SELETTORE AUTOMATICO COMUNE<br>AT, NC SELETTORE AUTOMATICO CONTATTO CHIUSO<br>AT.NO SELETTORE AUTOMATICO CONTATTO APERTO |   |   |   |   |   |   |   |   |
| E | PD.COM SELETTORE PEDALE COMUNE<br>PD.NC SELETTORE PEDALE CONTATTO CHIUSO<br>PD.NO SELETTORE PEDALE CONTATTO APERTO              | PD.COM SELETTORE PEDALE COMUNE<br>PD.NC SELETTORE PEDALE CONTATTO CHIUSO<br>PD.NO SELETTORE PEDALE CONTATTO APERTO              |   |   |   |   |   |   |   |   |
| F |   |   |   |   |   |   |   |   |   |   |

EMERGENCY

CLOSED CONTACT FOR EMERGENCY

OPENED CONTACT FOR EMERGENCY

EMERGENCY LAMP

EMERGENCY LAMP

WIRE LAMP

WIRE LAMP

LIMIT SWITCH

LIMIT SWITCH

LIMIT SWITCH

LIMIT SWITCH

FOOTSWITCH

FOOTSWITCH

AUTOMATIC SWITCH

AUTOMATIC SWITCH FOR CLOSED CONTACT

AUTOMATIC SWITCH FOR OPENED CONTACT

FOODSWITCH

FOOTSWITCH FOR CLOSED CONTACT

FOOTSWITCH FOR OPENED CONTACT

|                       |          |               |          |           |  |
|-----------------------|----------|---------------|----------|-----------|--|
| <b>ABM COMPANYSrl</b> | Impianto |               | FOGLIO   |           |  |
|                       | Dis. N.  |               | 3        |           |  |
|                       | CAD      | SPAC          | Commissa |           |  |
| Nome File             |          | Denominazione |          | Esecutore |  |
| Data                  |          | LEGENDA       |          | 4         |  |

**ABM COMPANYSrl**

# NEW INVERTER CONNECTION F4000

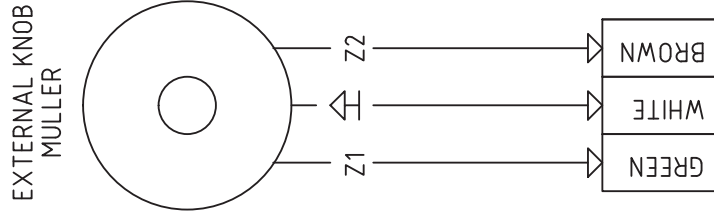
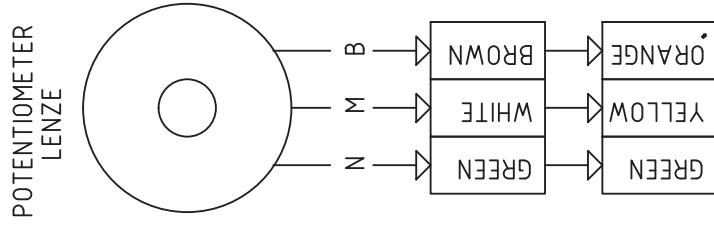
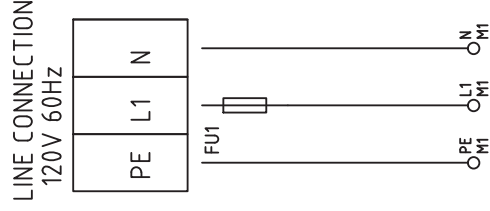
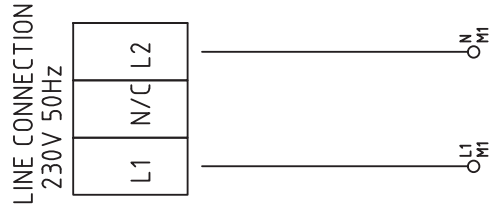
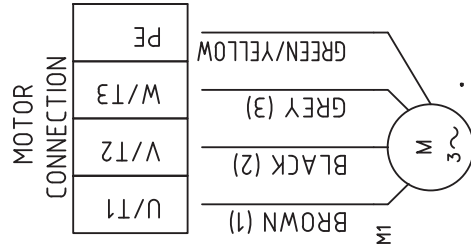
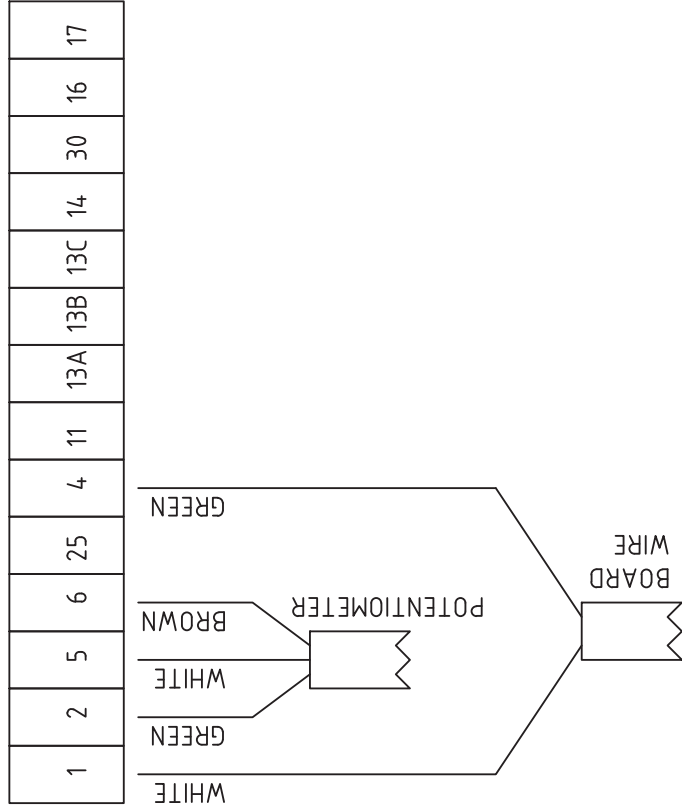

# ABM COMPANYSrl

Dis. N.

CAD **SPAC**

Nome File

Data

Impianto

**F4000**

Denominazione  
**CONNESSIONE NUOVO INVERTER F4000**  
**NEW INVERTER CONNECTION F4000**

Ordine

Commessa

Esecutore

FOGLIO

**5**

SEGUE

**6**

0 1 2 3 4 5 6 7 8 9

A B C D E F

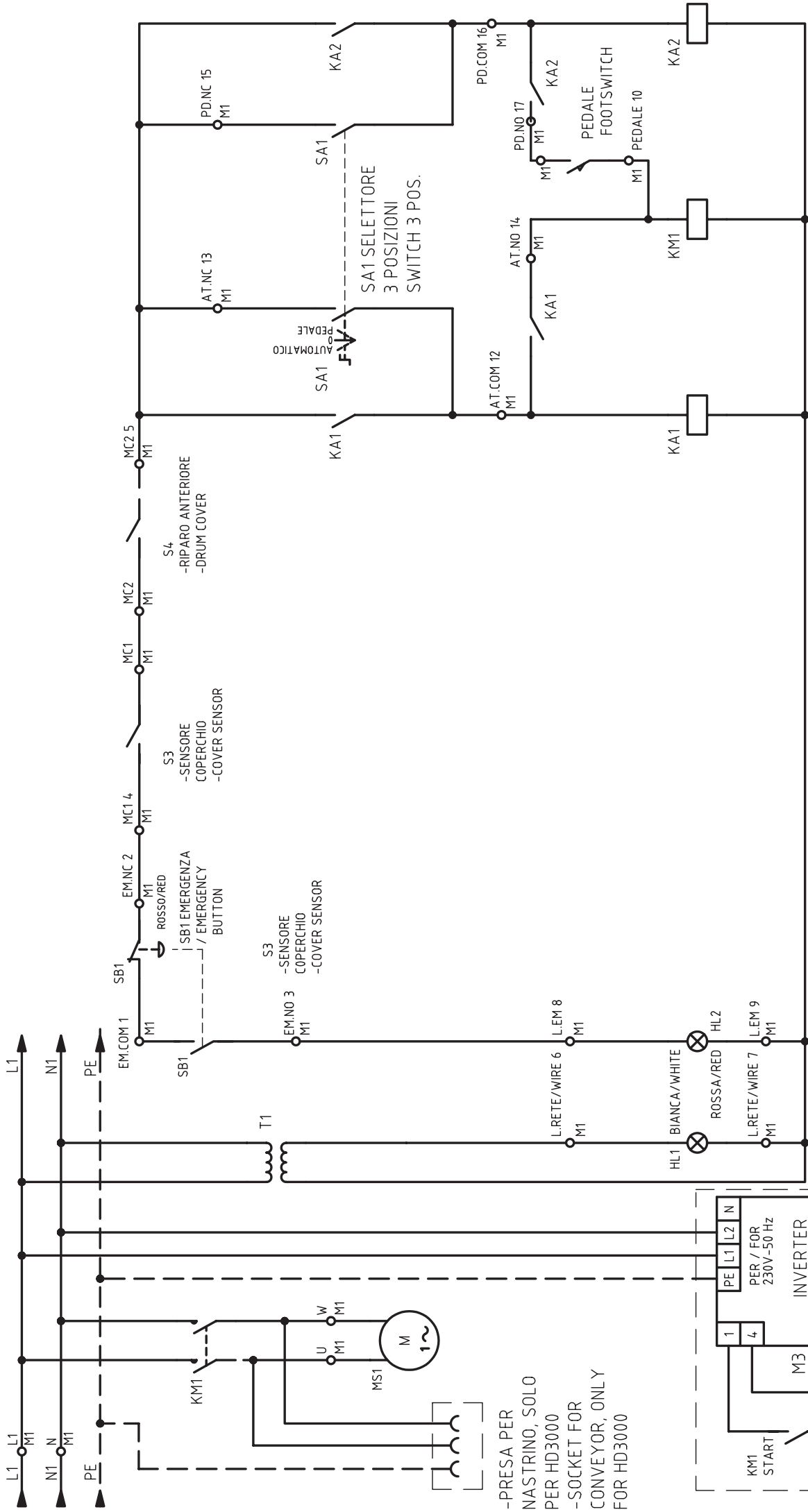

-PRESA PER  
NASTRINO, SOLO  
PER HD3000  
-SOCKET FOR  
CONVEYOR, ONLY  
FOR HD3000

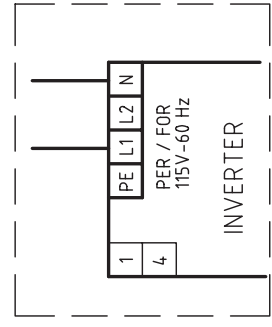
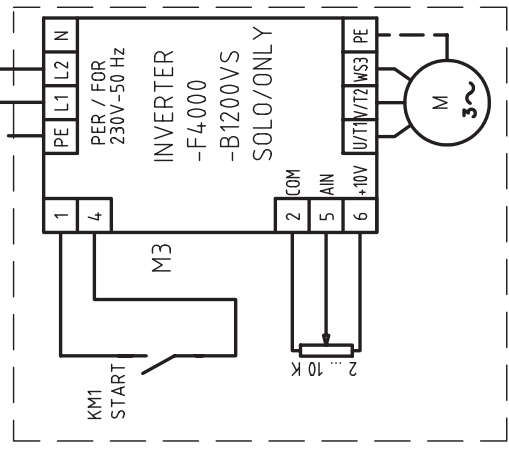

|               |  |   |  |                                      |  |  |  |
|---------------|--|---|--|--------------------------------------|--|--|--|
| DENOMINAZIONE |  | SCHEMA ELETTRICO FORMATRICI F2000-F3000-F4000-B1200-B1200NS   |  | NFZ. -- --                           |  | MATERIALE -- --                        |  |
| GRUPPO        |  | WIRING DIAGRAM FOR PATTY MACHINES F2000-F3000-F4000-B1200-B1200NS   |  |                                      |  | TRATT. TERMICO 0 -- --<br>SUPERFICIALE |  |
| MACCHINA      |  | FORMATRICE - PATTY FORMING MACHINE NSF-ETL VERSION  |  | SCALA                                |  |  |  |
|               |  | ABM SRL 20020 - LAINATE - MI  |  | DATA                                 |  | 17/07/2014                             |  |
|               |  | TEL ++39 02 937 37 81 - FAX ++39 02 937 90 148  |  | WWW.ABMCOMPANY.COM abm@abcompany.com |  | VER.                                   |  |
|               |  | QUESTO DISEGNO E' DI NOSTRA PROPRIETA'. NON PUO' ESSERE RIPRODOTTO O TRASFERITO A TERZI SENZA NOSTRA AUTORIZZAZIONE. AUTORIZZAZIONE E' DA RITORNARE UPON OUR REQUEST. |  |                                      |  | ESEC.                                  |  |
|               |  |   |  |                                      |  | APPR.                                  |  |
|               |  |   |  |                                      |  | COD.                                   |  |



**ABM  
CONVEYOR BELT FOR HD 3000  
EDITION 2014-06-16**

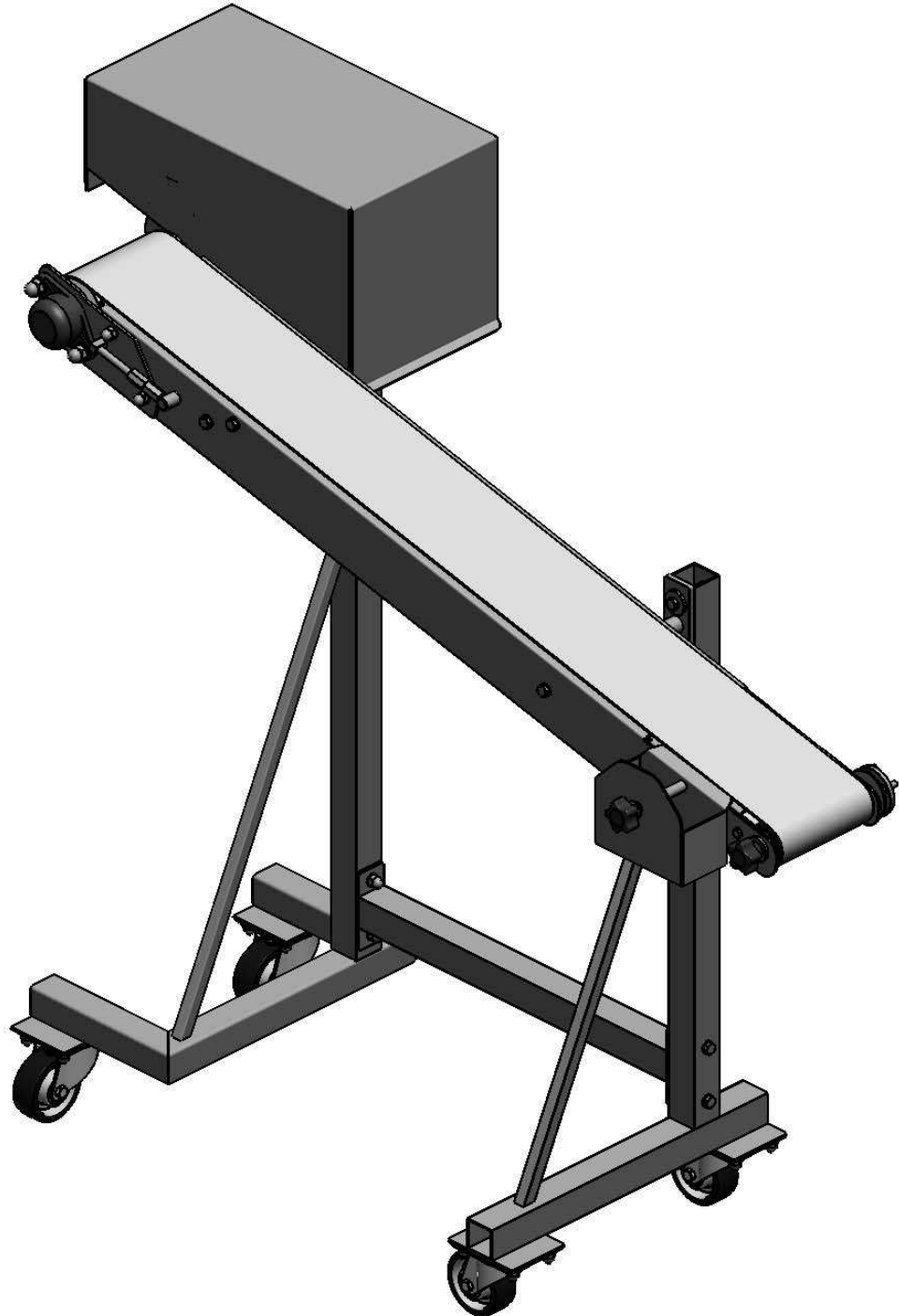



# ABM CONVEYOR BELT FOR HD 3000

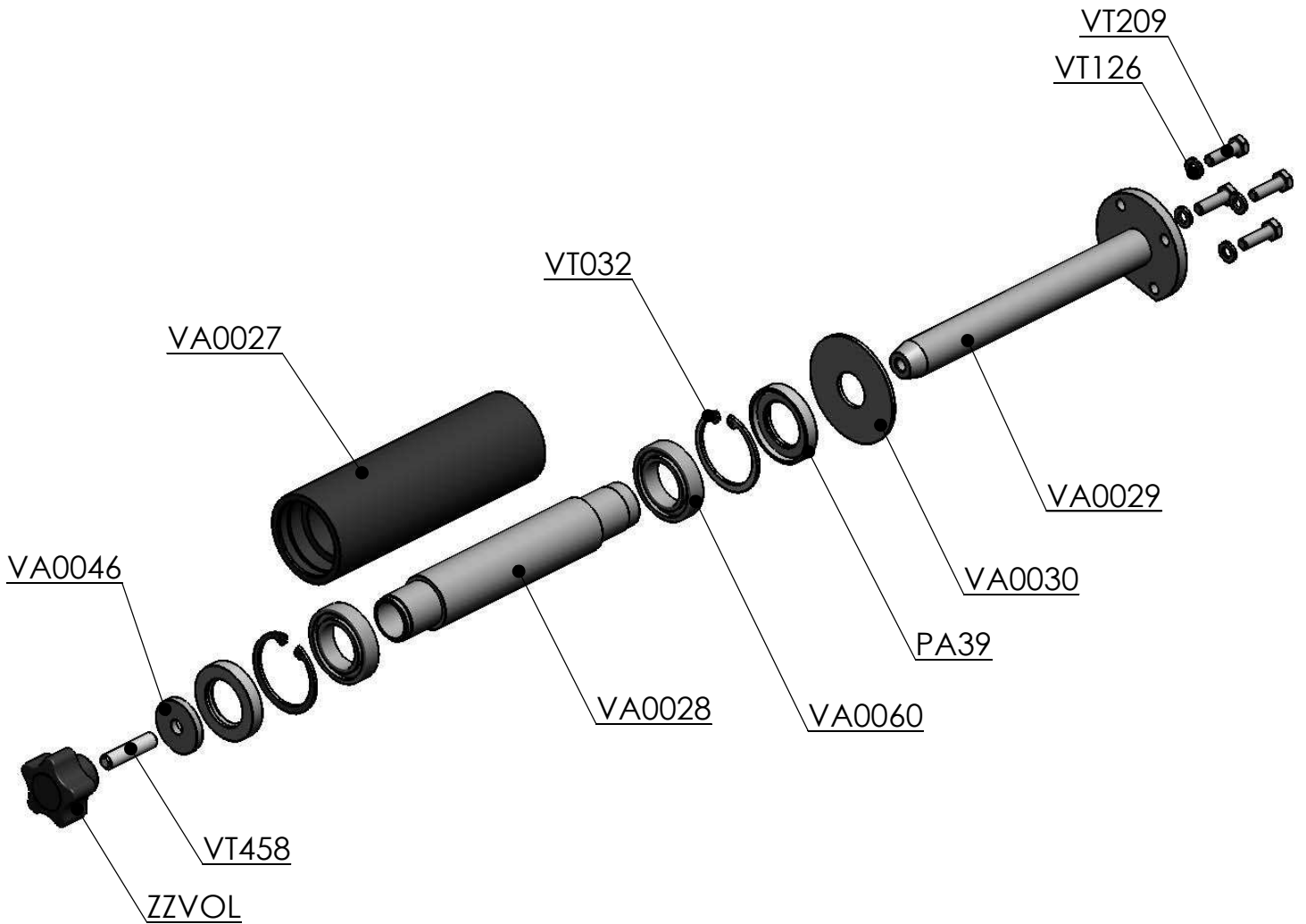

| CODE   | DESCRIPTION                                   |
|--------|---|
| PA39   | SEAL 25-42-7                                  |
| VA0027 | ROLL OF REFERENCE                             |
| VA0028 | SHAFT OF REFERENCE FOR ROLLER                 |
| VA0029 | SHAFT ALIGNMENT                               |
| VA0030 | DISK  |
| VA0046 | FLAT WASHER Ø30                               |
| VA0060 | BEARING 61905-2RS (25-42-9)                   |
| VT032  | RETAINING RING INTERNAL M42 SS                |
| VT126  | FLAT WASHER M6 SS                             |
| VT209  | HEX HEAD SCREW M6-1.0x20 SS                   |
| VT458  | HEX SOCKET SET SCREW FLAT POINT M8-1.25x35 SS |
| ZZVOL  | KNOB Ø40 M8 FEMALE                            |



# ABM CONVEYOR BELT FOR HD 3000

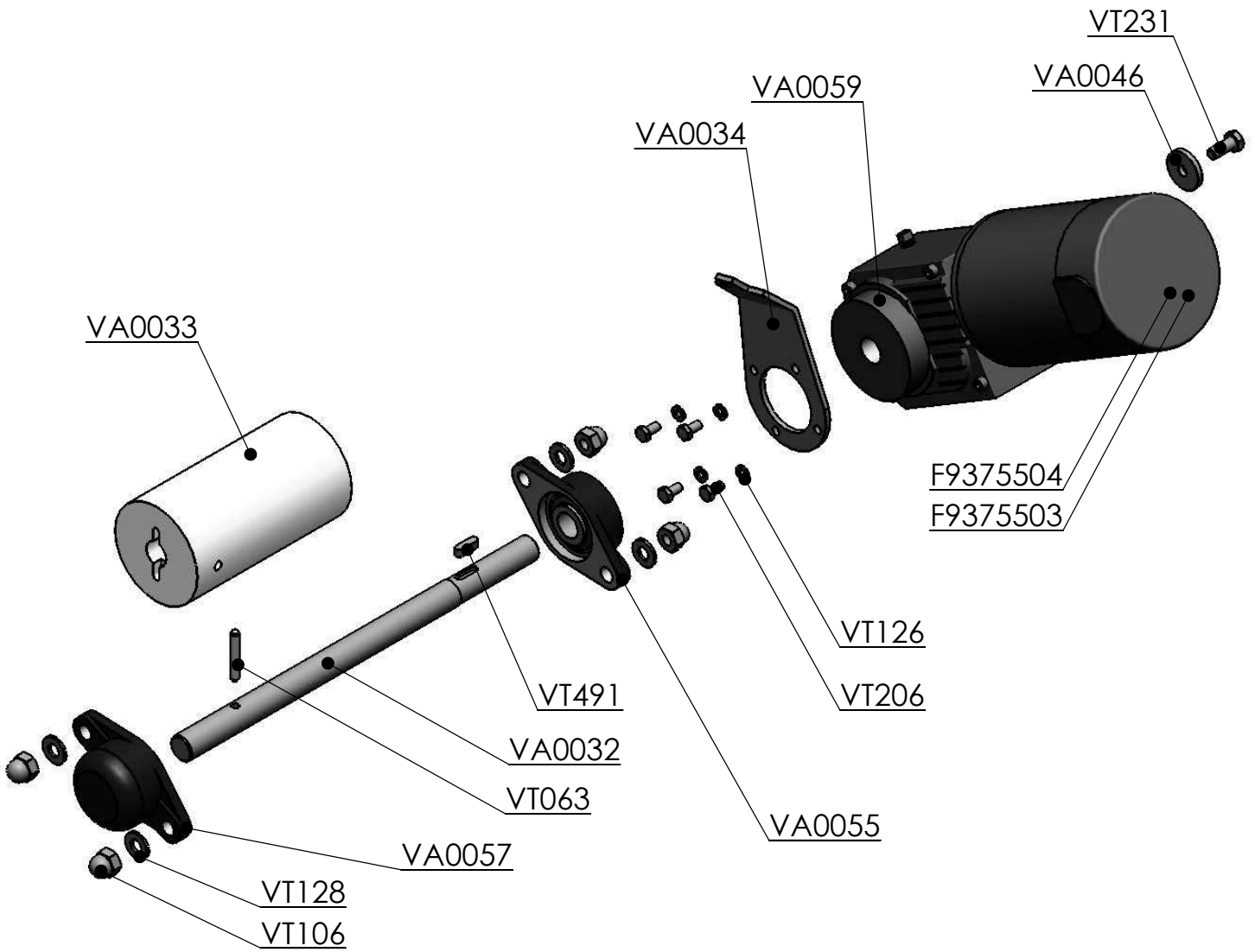

| CODE     | DESCRIPTION  |
|----------|--|
| F9375503 | MOTOR Kw 0,18 - Gr.63 - B14 - 230V SINGLE PHASE - IP55 + CAPACITOR 8 $\mu$ F |
| F9375504 | MOTOR Kw 0,18 - Gr.63 - B14 - 115V-60Hz - IP55 + CAPACITOR 25 $\mu$ F        |
| VA0032   | SHAFT ROLLER MOTOR   |
| VA0033   | ROLLER MOTOR   |
| VA0034   | REACTION ARM   |
| VA0046   | FLAT WASHER $\varnothing$ 30   |
| VA0055   | PLASTIC SUPPORT UCFL 204 OPEN COD.69026                                      |
| VA0057   | PLASTIC SUPPORT UCFL 204 CLOSED COD.69016                                    |
| VA0059   | GEAR MT MRV40 RAPP 1:30 PAM 63 B14 VER. FOOD WHIT WHITE EPOXY COATING        |
| VT063    | PARRALLEL PIN M6m6x40 SS   |
| VT106    | ACORN HEX CAP M10-1.5 SS   |
| VT126    | FLAT WASHER M6 SS  |
| VT128    | FLAT WASHER M10 SS   |
| VT206    | HEX HEAD SCREW M6-1.0x12 SS  |
| VT231    | HEX HEAD SCREW M8-1.25x20 SS   |
| VT491    | KEY 6x6x20 INOX  |





# ABM CONVEYOR BELT FOR HD 3000

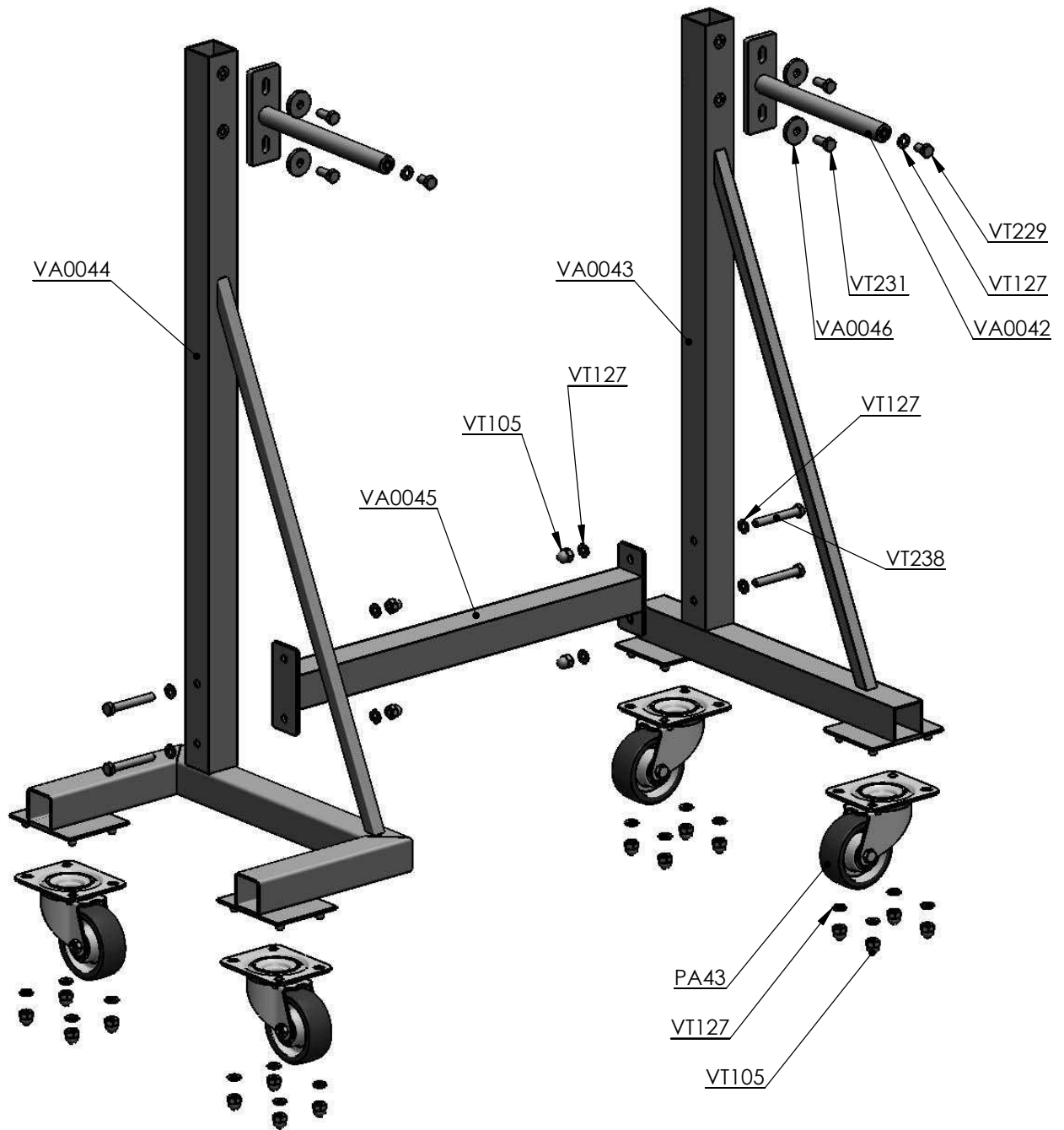

| CODE   | DESCRIPTION                  |
|--------|------------------------------|
| PA43   | PIVOTING WHEEL d.80 SS       |
| VA0042 | SUPPORT BAR                  |
| VA0043 | SHORT LEG                    |
| VA0044 | LONG LEG                     |
| VA0045 | CROSS LEG                    |
| VA0046 | FLAT WASHER Ø30              |
| VT105  | ACORN HEX CAP M8-1.25 SS     |
| VT127  | FLAT WASHER M8 SS            |
| VT229  | HEX HEAD SCREW M8-1.25x14 SS |
| VT231  | HEX HEAD SCREW M8-1.25x20 SS |
| VT238  | HEX HEAD SCREW M8-1.25x60 SS |



# ABM CONVEYOR BELT FOR HD 3000

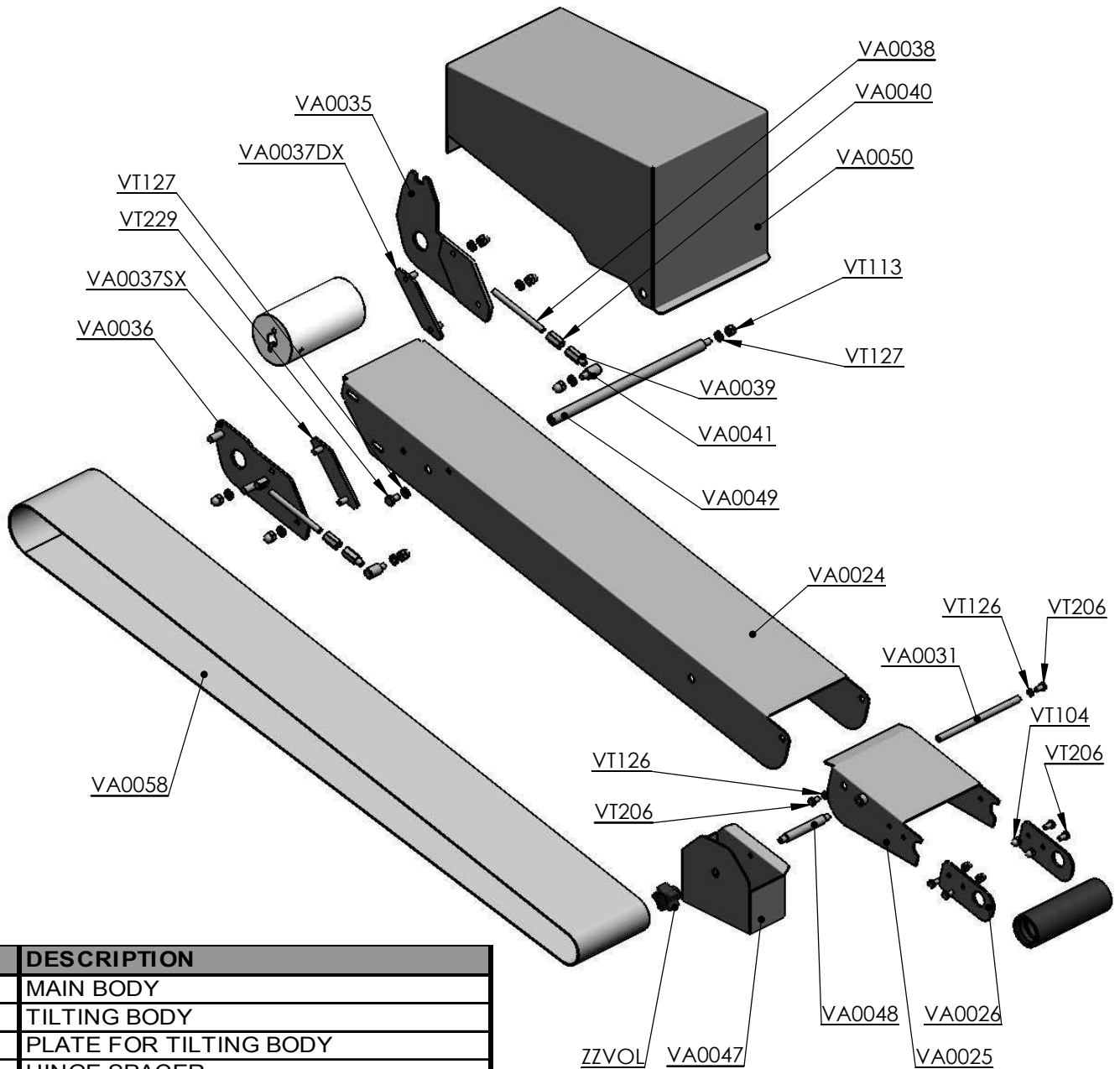

| CODE     | DESCRIPTION                      |
|----------|----------------------------------|
| VA0024   | MAIN BODY                        |
| VA0025   | TILTING BODY                     |
| VA0026   | PLATE FOR TILTING BODY           |
| VA0031   | HINGE SPACER                     |
| VA0035   | PLATES RIGHT WITH REACTION       |
| VA0036   | PLATES LEFT                      |
| VA0037DX | PLATE WITH ROD RIGHT             |
| VA0037SX | PLATE WITH ROD LEFT              |
| VA0038   | ROD                              |
| VA0039   | BLIND NUT                        |
| VA0040   | THROUGH NUT                      |
| VA0041   | PIVOT BUSH                       |
| VA0047   | BOX SCRAP COLLECTION             |
| VA0048   | ROD MOUNTING BOX                 |
| VA0049   | HINGE PIN FOR CARTER             |
| VA0050   | CARTER OF MOTOR                  |
| VA0058   | BELT 1N4B07PA_HBHACCP 145 X 2440 |
| VT104    | ACORN HEX CAP M6-1.0 SS          |
| VT113    | NYLOK NUT M8-1.25 SS             |
| VT126    | FLAT WASHER M6 SS                |
| VT127    | FLAT WASHER M8 SS                |
| VT206    | HEX HEAD SCREW M6-1.0x12 SS      |
| VT229    | HEX HEAD SCREW M8-1.25x14 SS     |
| ZZVOL    | KNOB Ø40 M8 FEMALE               |



THE BIRO MANUFACTURING COMPANY  
1114 W. Main Street  
Marblehead, Ohio 43440 U.S.A.  
Ph. 419-798-4451 Fax 419-798-9106  
[service@birosaw.com](mailto:service@birosaw.com); [www.birosaw.com](http://www.birosaw.com)